



LASTING

ELEGANT

ADAPTIVE

PRACTICAL



Laboratory Solutions

A Leap From Concept to Reality



LEAP range of laboratory furniture brought to you by Laboratory Solutions and H&H Scientific. A new era in long-lasting, elegant, adaptable and practical laboratory furniture. Build to European standards using European raw material and hardware.

- European Standards
- Customized Solutions
- Reasonable Price
- Quick Delivery

CONTENTS

Introduction	4-7
LEAP Cabinet Series	8-34
Plinth Based	8
Mobile	15
Hanging	21
Sink	27
Fume Hood Base	28
Wall	30
Tall Storage	32
Panels	34
Utility Spine	35-38
Utility Spine for Wall Assembly	36
Utility Spine for Island Assembly	37
Overhead Service Spine	38
Service Drop	38
Frames & Tables	39-42
C-frame	39
H-frame	40
C-frame (Heavy Duty)	41
Mobile Table	42
Stainless Steel Table	43
Crank Operated Table	43
Vibration Isolation Table	43
Fume Hoods	45-52
Bench Mounted Fume Hood	47
Fume Hood for Low Rooms	49
Distillation Fume Hood	50
Walk-in Fume Hood	51
Metal Fume Hoods	53-58
Standard Pro Series Bench Top Fume Hood	54
Safeguard Bench Top Fume Hood	55
Distillation Fume Hood	56
Walk-in Fume Hood	57
Canopy Hoods	58
Biological Safety	59-60
Worksurface	61-64
Accessories	65-72
Sinks	65
Pegboards	67
Plumbing Fixtures	68
Lab Safety	69
Electrical Trunking	70
Extraction Arms	71
Shelving	72
Safety Cabinets	73-76
Specs & Options	77

INTRODUCTION

Overview

Laboratory Solutions originated from the idea of translating design concept into tangible product. A product that is designed and built to withstand test of time and stringent laboratory environment. Laboratory Solutions is specialized in fabrication of quality laboratory furniture including a range of cabinets and countertops. Our aim is to produce European quality furniture at a very competitive price.

The company was established in 2015 in Sharjah SAIF zone with state of the art European machinery, manned by highly skilled and experienced work force. Laboratory Solutions provides comprehensive laboratory furnishing solutions for customers willing to either build a new lab or revamp existing laboratory.



Product Range

Laboratory Solutions offers following range of products manufactured by highest grade melamine faced particle boards, high pressure laminates and phenolic resin:

- Plinth Based casework
- Mobile Cabinets
- Suspended casework
- Storage Cabinets
- Fume Hoods
- Enclosures

In addition to Laboratory Furniture, our manufacturing facility is geared to offer nurse stations, reception counters and office furniture.



Planning

Successful outcome of any project depends on its successful planning.

At Laboratory Solutions planning starts with understanding core project requirements and developing a solution that best meets customer's aspirations from management to end users.

At Laboratory Solutions our planning team has decades of experience on planning laboratories for educational, research and industrial sectors.

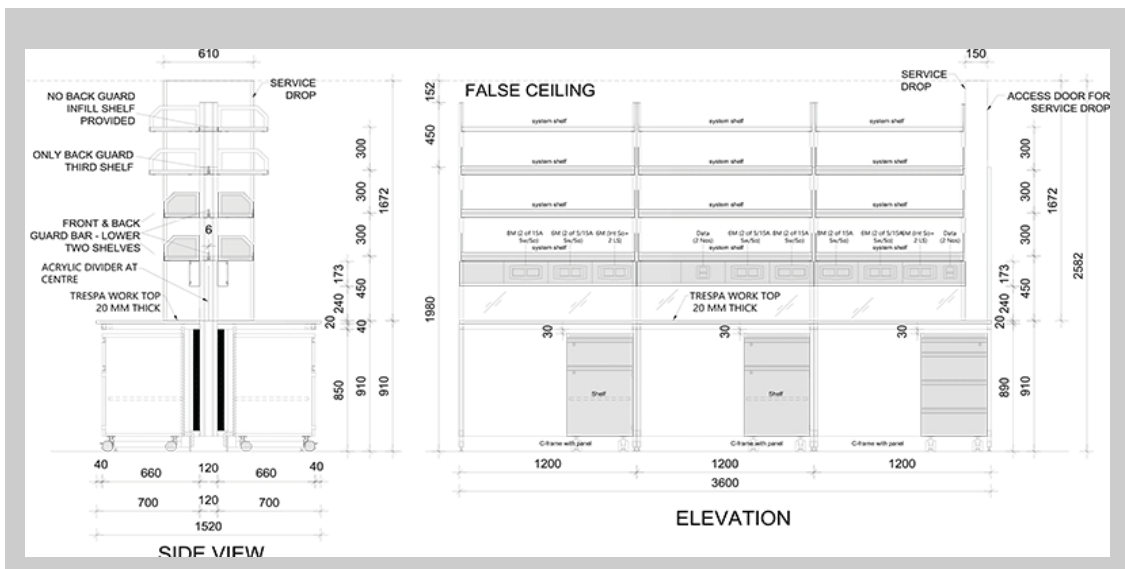

Design

Our team of dedicated CAD and graphic designers interpret customer inputs into actual drawings with plans, elevations, isometric views and rendered 3D walk through.

On successful approval of design, a proposal with specifications and costing is provided to the customer.

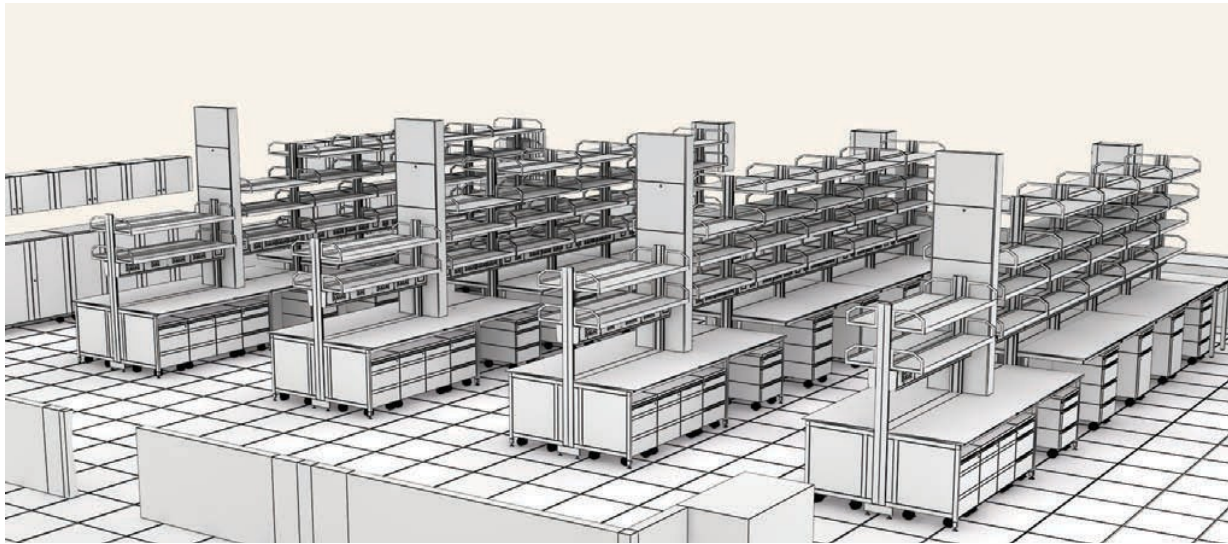

Production

Our production facility is equipped with latest machinery from Germany and Italy. All raw material and cabinet hardware used is of highest quality, sourced from Europe. Our facility is run by highly experienced and dedicated workforce of engineers, designers, technicians and laborers.

With an eye for detail, highly skilled workmanship and rigorous quality control procedures, we pride in producing products of exceptional quality.

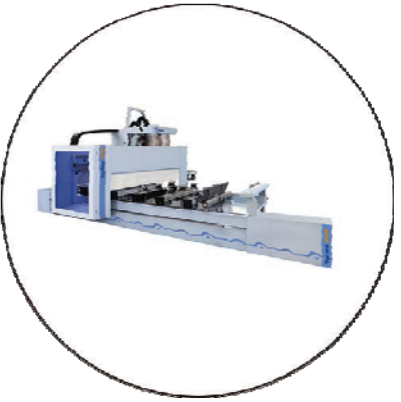
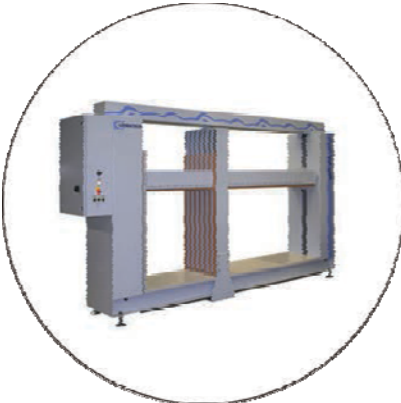

LEAP CABINET SERIES

Plinth Based - Standing Height

Open Cabinets

- 890mm Height
- 550mm Depth
- 2 Adjustable Shelves

Part#	Width (mm)	Doors	Drawers
P103000	300	-	-
P104500	450	-	-
P105000	500	-	-
P106000	600	-	-
P107500	750	-	-
P109000	900	-	-
P110000	1000	-	-
P112000	1200	-	-

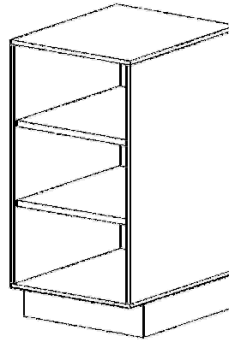

300/450/500/600mm

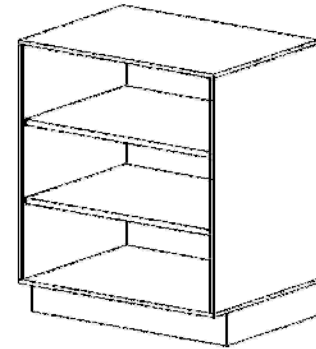

750/900/1000/1200mm

Plinth Based - Sitting Height

Open Cabinets

- 730mm Height
- 550mm Depth
- 2 Adjustable Shelves

Part#	Width (mm)	Doors	Drawers
P203000	300	-	-
P204500	450	-	-
P205000	500	-	-
P206000	600	-	-
P207500	750	-	-
P209000	900	-	-
P210000	1000	-	-
P212000	1200	-	-

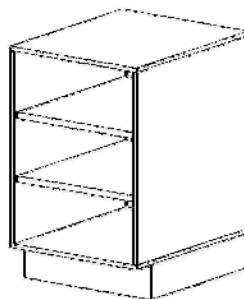

300/450/500/600mm

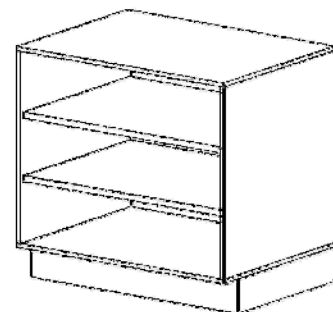

750/900/1000/1200mm

Plinth Based - Standing Height

Full Door Cabinets

- 890mm Height
- 550mm Depth
- 1 Adjustable Shelf

Part#	Width (mm)	Doors	Drawers
P10450R	450	1 Right Hinged	-
P10450L	450	1 Left Hinged	-
P10500R	500	1 Right Hinged	-
P10500L	500	1 Left Hinged	-
P10600R	600	1 Right Hinged	-
P10600L	600	1 Left Hinged	-
P107502	750	2	-
P109002	900	2	-
P110002	1000	2	-
P112002	1200	2	-

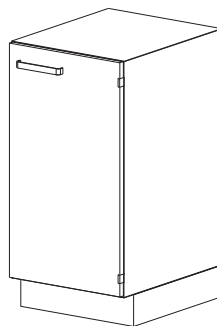

450/500/600mm

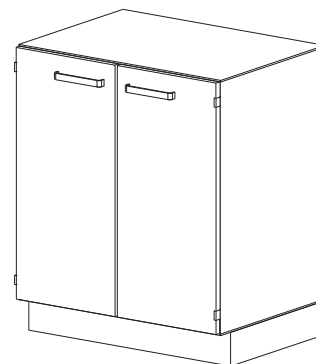

750/900/1000/1200mm

Door / Drawer Cabinets

- 890mm Height
- 550mm Depth
- Self-closing and damping drawer runners
- 1 Adjustable Shelf

Part#	Width (mm)	Doors	Drawers
P10451R	450	1 Right Hinged	-
P10451L	450	1 Left Hinged	-
P10501R	500	1 Right Hinged	-
P10501L	500	1 Left Hinged	-
P10601R	600	1 Right Hinged	-
P10601L	600	1 Left Hinged	-
P107512	750	2	-
P109012	900	2	-
P110012	1000	2	-
P112012	1200	2	-

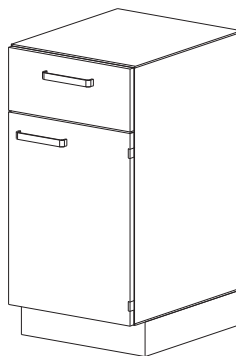

450/500/600mm

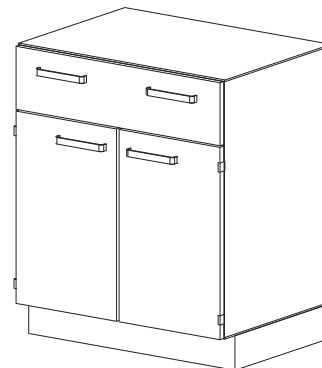

750/900/1000/1200mm

Plinth Based - Standing Height

Two Drawer Cabinets

- 890mm Height
- 550mm Depth
- Self-closing and damping drawer runners
- 2 Deep Drawers

Part#	Width (mm)	Doors	Drawers
P104520	450	-	2
P105020	500	-	2
P106020	600	-	2
P107520	750	-	2
P109020	900	-	2
P110020	1000	-	2
P112020	1200	-	2

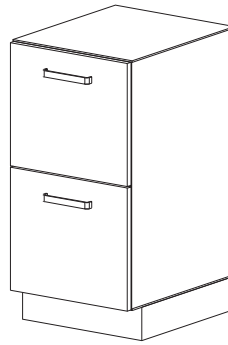

450/500/600mm

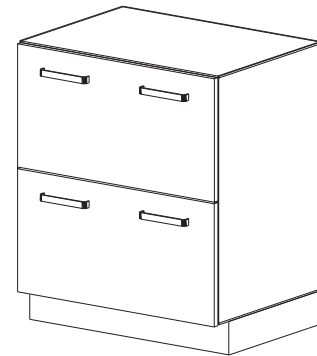

750/900/1000/1200mm

Three Drawer Cabinets

- 890mm Height
- 550mm Depth
- 2 Top Shallow Drawers
- Bottom Deep Drawer
- Self-closing and damping drawer runners

Part#	Width (mm)	Doors	Drawers
P104530	450	-	3
P105030	500	-	3
P106030	600	-	3
P107530	750	-	3
P109030	900	-	3
P110030	1000	-	3
P112030	1200	-	3

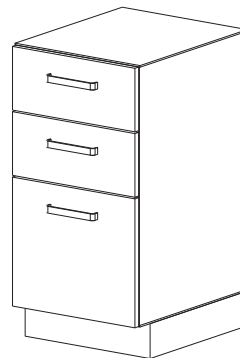

450/500/600mm

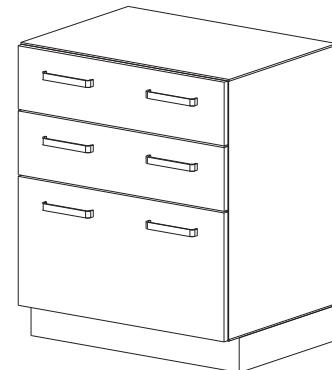

750/900/1000/1200mm

Plinth Based - Standing Height

Four Drawer Cabinets

- 890mm Height
- 550mm Depth
- Self-closing and damping drawer runners
- 4 Equal Height Drawers

Part#	Width (mm)	Doors	Drawers
P104540	450	-	4
P105040	500	-	4
P106040	600	-	4
P107540	750	-	4
P109040	900	-	4
P110040	1000	-	4
P112040	1200	-	4

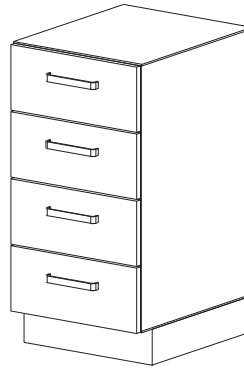

450/500/600mm



750/900/1000/1200mm



Plinth Based - Sitting Height

Full Door Cabinets

- 730mm Height
- 550mm Depth
- 1 Adjustable Shelf

Part#	Width (mm)	Doors	Drawers
P20450R	450	1 Right Hinged	-
P20450L	450	1 Left Hinged	-
P20500R	500	1 Right Hinged	-
P20500L	500	1 Left Hinged	-
P20600R	600	1 Right Hinged	-
P20600L	600	1 Left Hinged	-
P207502	750	2	-
P209002	900	2	-
P210002	1000	2	-
P212002	1200	2	-

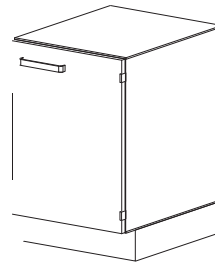

450/500/600mm

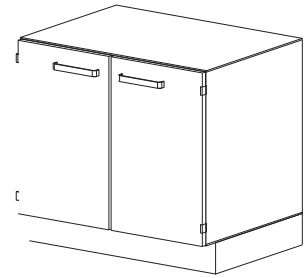

750/900/1000/1200mm

Door / Drawer Cabinets

- 730mm Height
- 550mm Depth
- 1 Adjustable Shelf
- 1 Top Drawer
- Self-closing and damping drawer runners

Part#	Width (mm)	Doors	Drawers
P20451R	450	1 Right Hinged	1
P20451L	450	1 Left Hinged	1
P20501R	500	1 Right Hinged	1
P20501L	500	1 Left Hinged	1
P20601R	600	1 Right Hinged	1
P20601L	600	1 Left Hinged	1
P207512	750	2	1
P209012	900	2	1
P210012	1000	2	1
P212012	1200	2	1

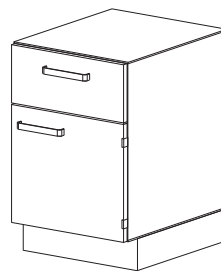

450/500/600mm

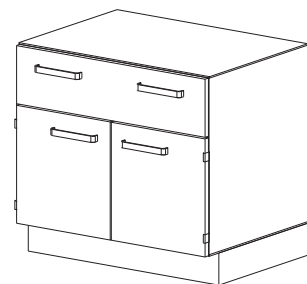

750/900/1000/1200mm

Plinth Based - Sitting Height

Two Drawer Cabinets

- 730mm Height
- 550mm Depth
- 1 Top Shallow Drawer
- 1 Bottom Deep Drawer
- Self-closing and damping drawer runners

Part#	Width (mm)	Doors	Drawers
P204520	450	-	2
P205020	500	-	2
P206020	600	-	2
P207520	750	-	2
P209020	900	-	2
P210020	1000	-	2
P212020	1200	-	2

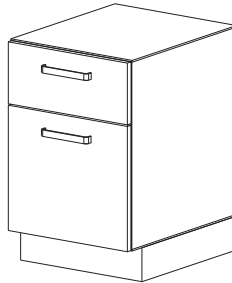

450/500/600mm

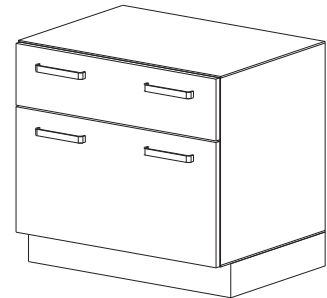

750/900/1000/1200mm

Three Drawer Cabinets

- 730mm Height
- 550mm Depth
- 3 Equal Height Drawers
- Self-closing and damping drawer runners

Part#	Width (mm)	Doors	Drawers
P204530	450	-	3
P205030	500	-	3
P206030	600	-	3
P207530	750	-	3
P209030	900	-	3
P210030	1000	-	3
P212030	1200	-	3

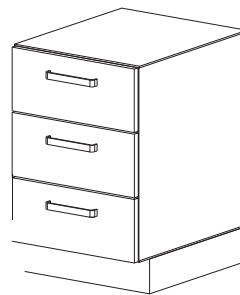

450/500/600mm

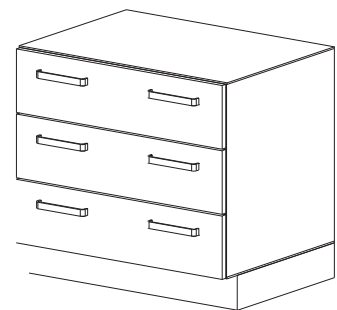

750/900/1000/1200mm

Plinth Based - Sitting Height

Four Drawer Cabinets

- 730mm Height
- Self-closing and damping drawer runners
- 550mm Depth
- 4 Shallow Drawers

Part#	Width (mm)	Doors	Drawers
P204540	450	-	4
P205040	500	-	4
P206040	600	-	4
P207540	750	-	4
P209040	900	-	4
P210040	1000	-	4
P212040	1200	-	4

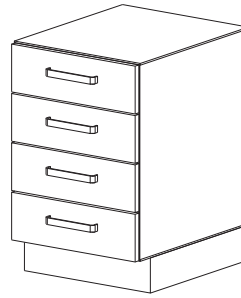

450/500/600mm

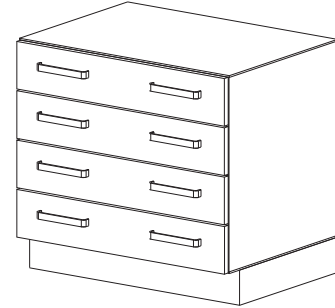

750/900/1000/1200mm



Mobile - Standing Height

Full Door Cabinets

- 820mm Height
- 550mm Depth
- 1 Adjustable Shelf
- Finished Top and Back
- Four castors with front 2 lockable

Part#	Width (mm)	Doors	Drawers
M10450R	450	1 Right Hinged	-
M10450L	450	1 Left Hinged	-
M10500R	500	1 Right Hinged	-
M10500L	500	1 Left Hinged	-
M10600R	600	1 Right Hinged	-
M10600L	600	1 Left Hinged	-
M107502	750	2	-
M109002	900	2	-
M110002	1000	2	-
M112002	1200	2	-

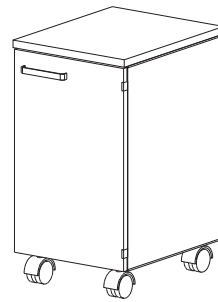

450/500/600mm

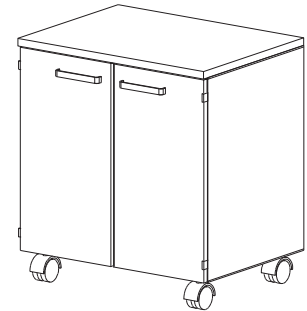

750/900/1000/1200mm

Door/Drawer Cabinets

- 820mm Height
- 550mm Depth
- 1 Adjustable Shelf
- Finished Top and Back
- Four castors with front 2 lockable
- Self-closing and damping drawer runner

Part#	Width (mm)	Doors	Drawers
M10451R	450	1 Right Hinged	1
M10451L	450	1 Left Hinged	1
M10501R	500	1 Right Hinged	1
M10501L	500	1 Left Hinged	1
M10601R	600	1 Right Hinged	1
M10601L	600	1 Left Hinged	1
M107512	750	2	1
M109012	900	2	1
M110012	1000	2	1
M112012	1200	2	1

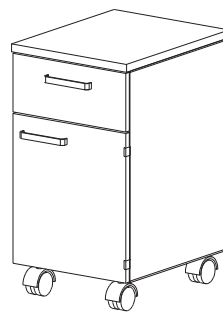

450/500/600mm

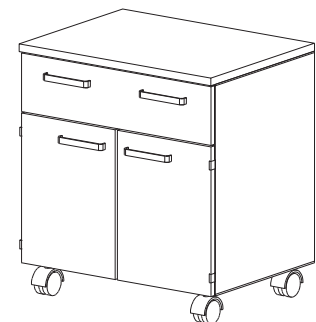

750/900/1000/1200mm

Mobile - Standing Height

Two Drawer Cabinets

- 820mm Height
- 550mm Depth
- 2 Deep Drawers
- Finished Top and Back
- Four castors with front 2 lockable
- Self-closing and damping drawer runners

Part#	Width (mm)	Doors	Drawers
M104520	450	-	2
M105020	500	-	2
M106020	600	-	2
M107520	750	-	2
M109020	900	-	2
M110020	1000	-	2
M112020	1200	-	2

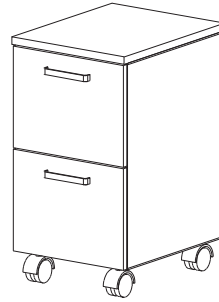

450/500/600mm

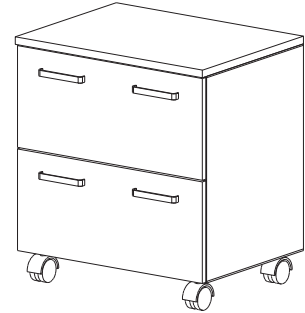

750/900/1000/1200mm

Three Drawer Cabinets

- 820m Height
- 550mm Depth
- 2 Top Shallow Drawers
- 1 Bottom Deep Drawer
- Four castors with front 2 lockable
- Self-closing and damping drawer runners

Part#	Width (mm)	Doors	Drawers
M104530	450	-	3
M105030	500	-	3
M106030	600	-	3
M107030	750	-	3
M109030	900	-	3
M110030	1000	-	3
M112030	1200	-	3

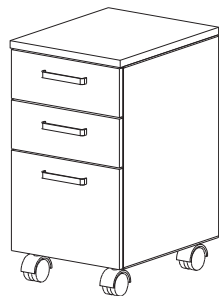

450/500/600mm

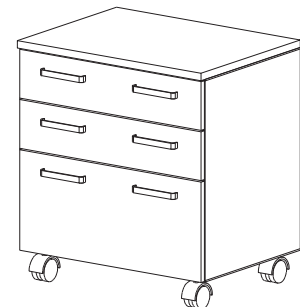

750/900/1000/1200mm

Mobile - Standing Height

Four Drawer Cabinets

- 820mm Height
- 550mm Depth
- 4 Equal Height Drawers
- Finished Top and Back
- 4 castors with front 2 lockable
- Self-closing and damping drawer runners

Part#	Width (mm)	Doors	Drawers
M104540	450	-	4
M105040	500	-	4
M106040	600	-	4
M107540	750	-	4
M109040	900	-	4
M110040	1000	-	4
M112040	1200	-	4

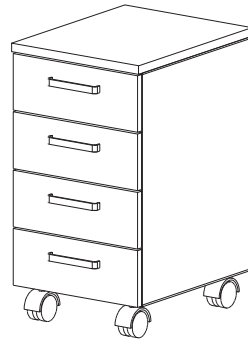

450/500/600mm



750/900/1000/1200mm



Mobile - Sitting Height

Full Door Cabinets

- 660mm Height
- 550mm Depth
- 1 Adjustable Shelf
- Finished Top and Back
- 4 castors with front 2 lockable

Part#	Width (mm)	Doors	Drawers
M20450R	450	1 Right Hinged	-
M20450L	450	1 Left Hinged	-
M20500R	500	1 Right Hinged	-
M20500L	500	1 Left Hinged	-
M20600R	600	1 Right Hinged	-
M20600L	600	1 Left Hinged	-
M207502	750	2	-
M209002	900	2	-
M210002	1000	2	-
M212002	1200	2	-

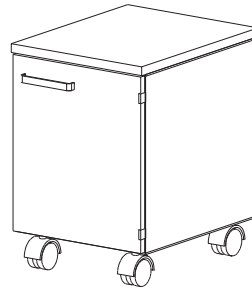

450/500/600mm

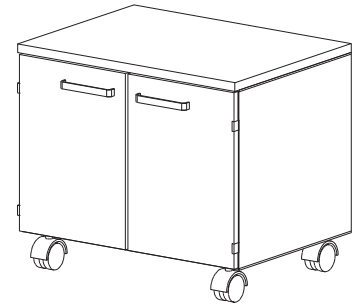

750/900/1000/1200mm

Door/Drawer Cabinets

- 660mm Height
- 550mm Depth
- 1 Adjustable Shelf
- Finished Top and Back
- 4 castors with front 2 lockable
- Self-closing and damping drawer runner

Part#	Width (mm)	Doors	Drawers
M20451R	450	1 Right Hinged	1
M20451L	450	1 Left Hinged	1
M20501R	500	1 Right Hinged	1
M20501L	500	1 Left Hinged	1
M20601R	600	1 Right Hinged	1
M20601L	600	1 Left Hinged	1
M207512	750	2	1
M209012	900	2	1
M210012	1000	2	1
M212012	1200	2	1

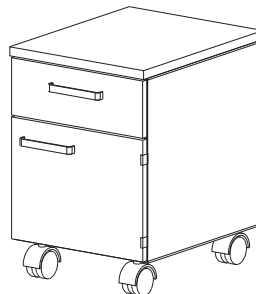

450/500/600mm

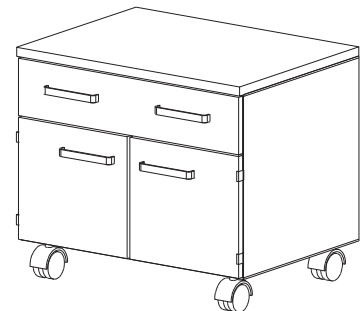

750/900/1000/1200mm

Mobile - Sitting Height

Two Drawer Cabinets

- 660mm Height
- 550mm Depth
- 1 Top Shallow Drawer
- 1 Bottom Deep Drawer
- Finished Top and Back
- Self-closing and damping drawer runners

Part#	Width (mm)	Doors	Drawers
M204520	450	-	2
M205020	500	-	2
M206020	600	-	2
M207520	750	-	2
M209020	900	-	2
M210020	1000	-	2
M212020	1200	-	2

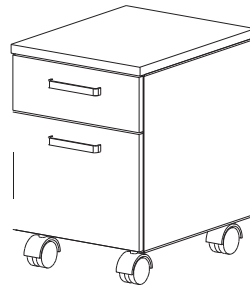

450/500/600mm

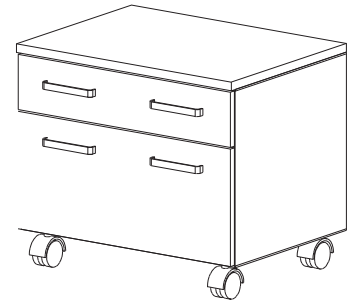

750/900/1000/1200mm

Three Drawer Cabinets

- 660mm Height
- 550mm Depth
- 3 Equal Height Drawers
- Finished Top and Back
- Four castors with front 2 lockable
- Self-closing and damping drawer runners

Part#	Width (mm)	Doors	Drawers
M204530	450	-	3
M205030	500	-	3
M206030	600	-	3
M207530	750	-	3
M209030	900	-	3
M210030	1000	-	3
M212030	1200	-	3

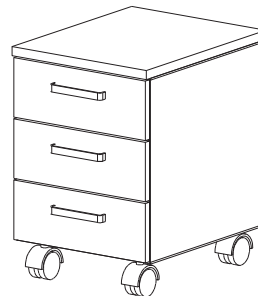

450/500/600mm

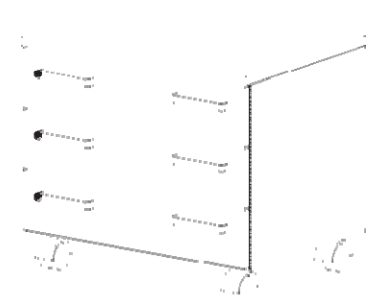

750/900/1000/1200mm

Mobile - Sitting Height

Four Drawer Cabinets

- 660mm Height
- 550mm Depth
- 4 Equal Height Drawers
- Finished Top and Back
- Four castors with front 2 lockable
- Self-closing and damping drawer runners

Part#	Width (mm)	Doors	Drawers
M204540	450	-	4
M205040	500	-	4
M206040	600	-	4
M207540	750	-	4
M209040	900	-	4
M210040	1000	-	4
M212040	1200	-	4

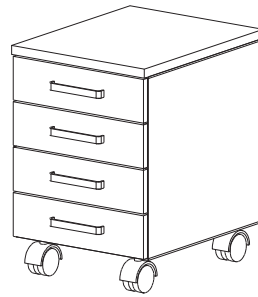

450/500/600mm

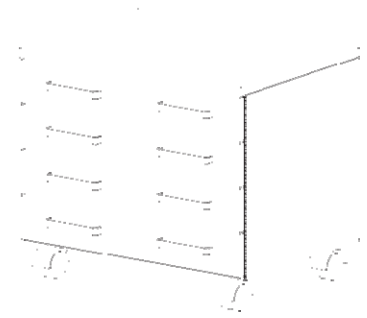

750/900/1000/1200mm



Hanging - Standing Height

Full Door Cabinets

- 665mm Height
- 550mm Depth
- 1 Adjustable Shelf
- Finished Top and Back
- Provision for suspending cabinet to C or H Frame

Part#	Width (mm)	Doors	Drawers
H10450R	450	1 Right Hinged	-
H10450L	450	1 Left Hinged	-
H10500R	500	1 Right Hinged	-
H10500L	500	1 Left Hinged	-
H10600R	600	1 Right Hinged	-
H10600L	600	1 Left Hinged	-
H107502	750	2	-
H109002	900	2	-
H110002	1000	2	-
H112002	1200	2	-

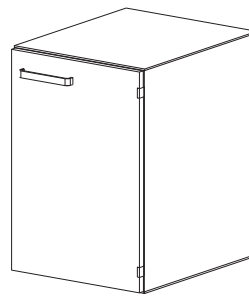

450/500/600mm

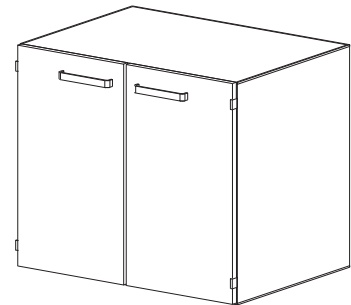

750/900/1000/1200mm

Door/Drawer Cabinets

- 665mm Height
- 550mm Depth
- 1 Adjustable Shelf
- Finished Top and Back
- Provision for suspending cabinet to C or H Frame
- Self-closing and damping drawer runner

Part#	Width (mm)	Doors	Drawers
H10451R	450	1 Right Hinged	1
H10451L	450	1 Left Hinged	1
H10501R	500	1 Right Hinged	1
H10501L	500	1 Left Hinged	1
H10601R	600	1 Right Hinged	1
H10601L	600	1 Left Hinged	1
H107512	750	2	1
H109012	900	2	1
H110012	1000	2	1
H112012	1200	2	1

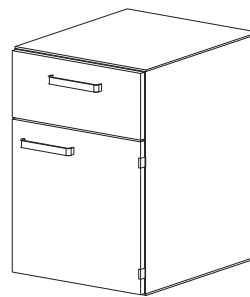

450/500/600mm

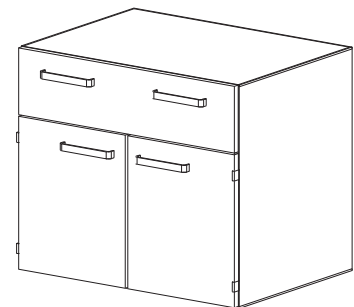

750/900/1000/1200mm

Hang ing - Standing Height

Two Drawer Cabinets

- 665mm Height
- 550mm Depth
- 2 Deep Drawers
- Finished Top and Back
- Provision for suspending cabinet to C or H Frame
- Self-closing and damping drawer runners

Part#	Width (mm)	Doors	Drawers
H104520	450	-	2
H105020	500	-	2
H106020	600	-	2
H107520	750	-	2
H109020	900	-	2
H110020	1000	-	2
H112020	1200	-	2

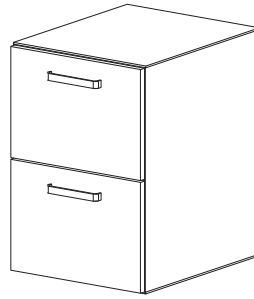

450/500/600mm

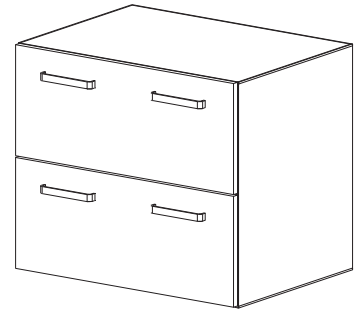

750/900/1000/1200mm

Three Drawer Cabinets

- 665mm Height
- 550mm Depth
- 2 Top Shallow Drawers
- 1 Bottom Deep Drawer
- Provision for suspending cabinet to C or H Frame
- Self-closing and damping drawer runners

Part#	Width (mm)	Doors	Drawers
H104530	450	-	3
H105030	500	-	3
H106030	600	-	3
H107530	750	-	3
H109030	900	-	3
H110030	1000	-	3
H112030	1200	-	3

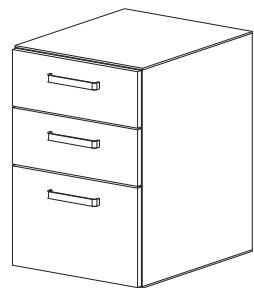

450/500/600mm

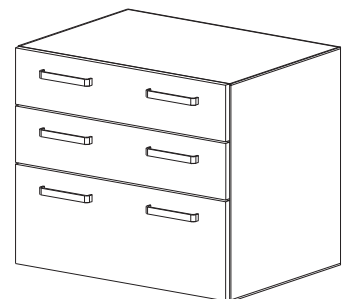

750/900/1000/1200mm

Hanging - Standing Height

Four Drawer Cabinets

- 665mm Height
- 550mm Depth
- 4 Equal Drawers
- Finished Top and Back
- Provision for suspending cabinet to C or H Frame
- Self-closing and damping drawer runners

Part#	Width (mm)	Doors	Drawers
H104540	450	-	4
H105040	500	-	4
H106040	600	-	4
H107540	750	-	4
H109040	900	-	4
H110040	1000	-	4
H112040	1200	-	4



450/500/600mm

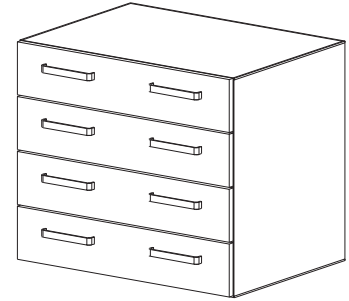

750/900/1000/1200mm



Hang ing - Sitting Height

Full Door Cabinets

- 498mm Height
- 550mm Depth
- 1 Adjustable Shelf
- Finished Top and Back
- Provision for suspending cabinet to C or H Frame

Part#	Width (mm)	Doors	Drawers
H20450R	450	1 Right Hinged	-
H20450L	450	1 Left Hinged	-
H20500R	500	1 Right Hinged	-
H20500L	500	1 Left Hinged	-
H20600R	600	1 Right Hinged	-
H20600L	600	1 Left Hinged	-
H207502	750	2	-
H209002	900	2	-
H210002	1000	2	-
H212002	1200	2	-

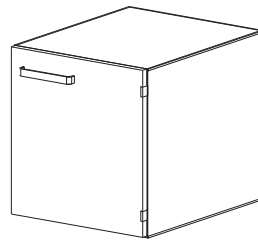

450/500/600mm

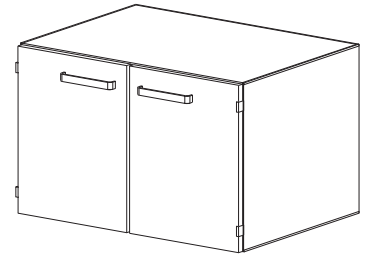

750/900/1000/1200mm

Door/Drawer Cabinets

- 498mm Height
- 550mm Depth
- 1 Adjustable Shelf
- Finished Top and Back
- Provision for suspending cabinet to C or H Frame
- Self-closing and damping drawer runner

Part#	Width (mm)	Doors	Drawers
H20451R	450	1 Right Hinged	1
H20451L	450	1 Left Hinged	1
H20501R	500	1 Right Hinged	1
H20501L	500	1 Left Hinged	1
H20601R	600	1 Right Hinged	1
H20601L	600	1 Left Hinged	1
H207512	750	2	1
H209012	900	2	1
H210012	1000	2	1
H212012	1200	2	1

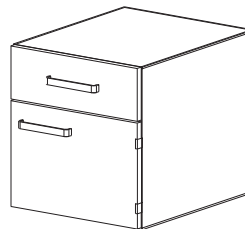

450/500/600mm

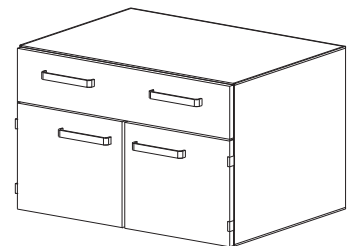

750/900/1000/1200mm

Hang ing - Sitting Height

Two Drawer Cabinets

- 498mm Height
- 550mm Depth
- 2 Equal Height Drawers
- Finished Top and Back
- Provision for suspending cabinet to C or H Frame
- Self-closing and damping drawer runners

Part#	Width (mm)	Doors	Drawers
H204520	450	-	2
H205020	500	-	2
H206020	600	-	2
H207520	750	-	2
H209020	900	-	2
H210020	1000	-	2
H212020	1200	-	2

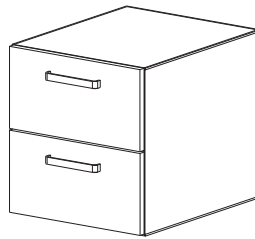

450/500/600mm

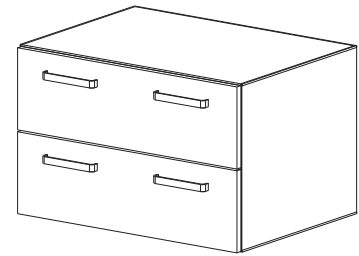

750/900/1000/1200mm

Three Drawer Cabinets

- 498mm Height
- 550mm Depth
- 2 Shallow and 1 Deep
- Finished Top and Back
- Provision for suspending cabinet to C or H Frame
- Self-closing and damping drawer runners

Drawers

Part#	Width (mm)	Doors	Drawers
H204530	450	-	3
H205030	500	-	3
H206030	600	-	3
H207530	750	-	3
H209030	900	-	3
H210030	1000	-	3
H212030	1200	-	3

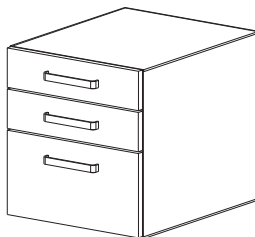

450/500/600mm

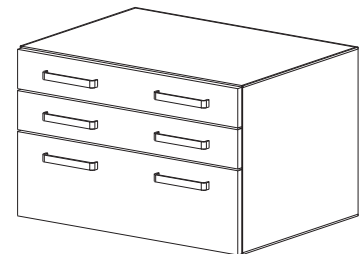

750/900/1000/1200mm

Hanging - Sitting Height

Four Drawer Cabinets

- 498mm Height
- 550mm Depth
- 4 Equal Height Drawers
- Finished Top and Back
- Provision for suspending cabinet to C or H Frame
- Self-closing and damping drawer runners

Part#	Width (mm)	Doors	Drawers
H204540	450	-	4
H205040	500	-	4
H206040	600	-	4
H207540	750	-	4
H209040	900	-	4
H210040	1000	-	4
H212040	1200	-	4

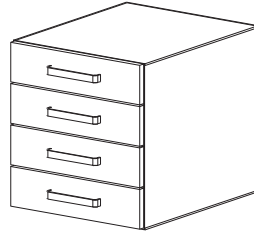

450/500/600mm

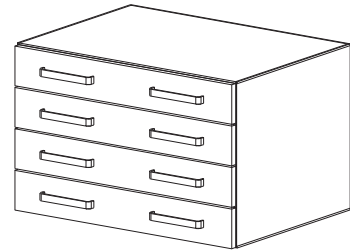

750/900/1000/1200mm

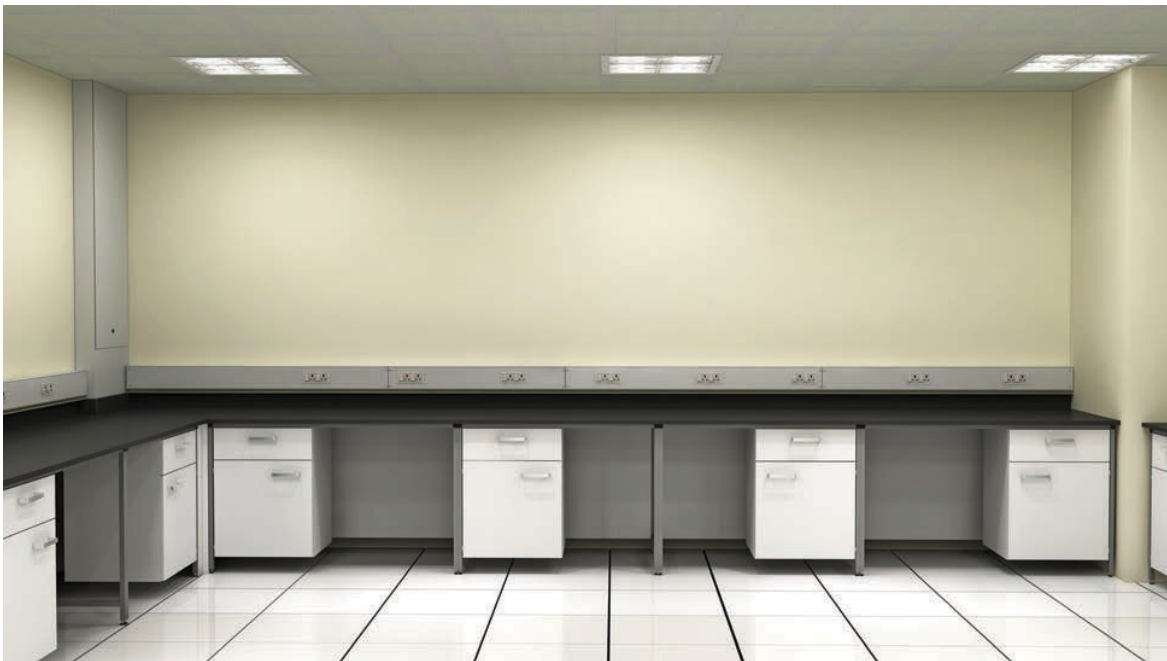

Sink Cabinets

Standing Height

- 890mm Height
- 550mm Depth
- Optional Waste Bin inserts available
- Open Top and Back

Part#	Width (mm)	Doors	Drawers
S10450R	450	1 Right Hinged	-
S10450L	450	1 Left Hinged	-
S10500R	500	1 Right Hinged	-
S10500L	500	1 Left Hinged	-
S10600R	600	1 Right Hinged	-
S10600L	600	1 Left Hinged	-
S107502	750	2	-
S109002	900	2	-
S110002	1000	2	-
S112002	1200	2	-

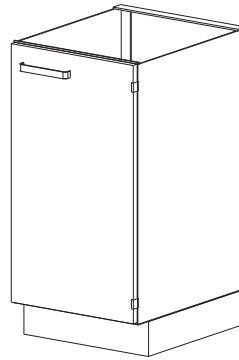

450/500/600mm

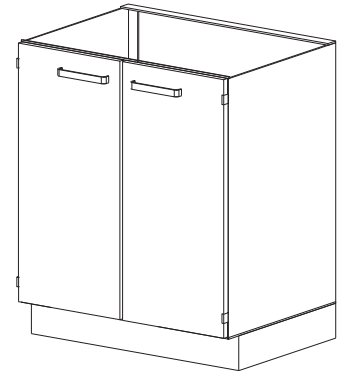

750/900/1000/1200mm

Sitting Height

- 730mm Height
- 550mm Depth
- Optional Waste Bin inserts available
- Open Top and Back

Part#	Width (mm)	Doors	Drawers
S20450R	450	1 Right Hinged	-
S20450L	450	1 Left Hinged	-
S20500R	500	1 Right Hinged	-
S20500L	500	1 Left Hinged	-
S20600R	600	1 Right Hinged	-
S20600L	600	1 Left Hinged	-
S207502	750	2	-
S209002	900	2	-
S210002	1000	2	-
S212002	1200	2	-

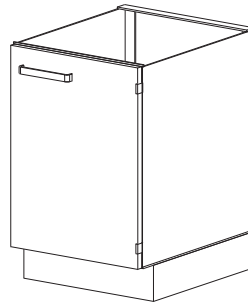

450/500/600mm

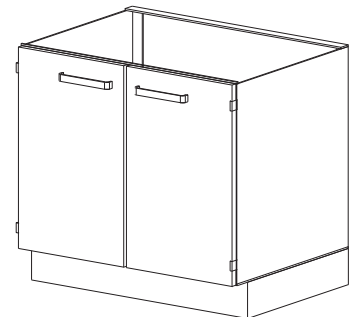

750/900/1000/1200mm

Fume Hood Base Cabinets

Standing Height

- 694mm Height
- 550mm Depth
- Finished Top and Back

Part#	Width (mm)	Doors	Drawers
F10500R	517	1 Right Hinged	-
F10500L	517	1 Left Hinged	-
F10600R	600	1 Right Hinged	-
F10600L	600	1 Left Hinged	-
F107502	750	2	-
F109002	900	2	-
F110002	1000	2	-
F111102	1117	2	-
F112002	1200	2	-

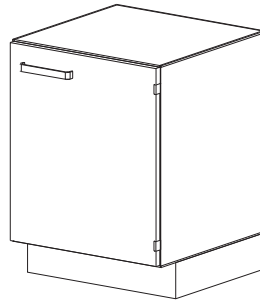

517/600mm

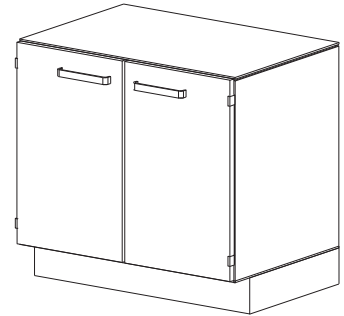

750/900/1000/1117/1200mm

Sitting Height

- 498mm Height
- 550mm Depth
- Movable
- Finished Top and Back

Part#	Width (mm)	Doors	Drawers
F20500R	517	1 Right Hinged	-
F20500L	517	1 Left Hinged	-
F20600R	600	1 Right Hinged	-
F20600L	600	1 Left Hinged	-
F207502	750	2	-
F209002	900	2	-
F210002	1000	2	-
F211102	1117	2	-
F212002	1200	2	-

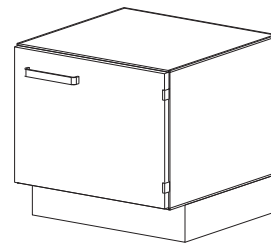

517/600mm

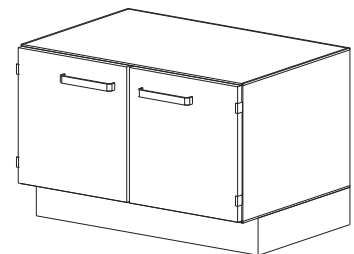

750/900/1000/1117/1200mm

Fume Hood Base Cabinets

Acid Storage Cabinets - Standing Height

- 694mm Height
- 550mm Depth
- Finished Top and Back
- Suitable for Acid/Alkali storage
- Provision for exhaust connection

Part# Standing Ht	Doors	Width (mm)
FA1500R	1 Right Hinged	517
FA1500L	1 Left Hinged	517
FA1600R	1 Right Hinged	600
FA1600L	1 Left Hinged	600
FA17502	2	750
FA11002	2	1000
FA11112	2	1117

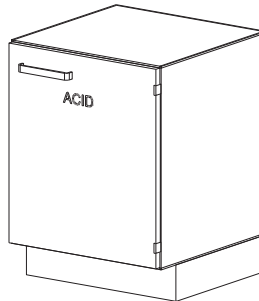

517/600mm

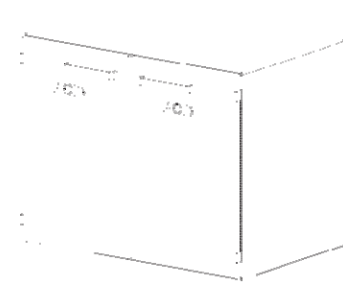

750/900/1000/1117/1200mm

Acid Storage Cabinets - Sitting Height

- 498mm Height
- 550mm Depth
- Finished Top and Back
- Suitable for Acid/Alkali storage
- Provision for exhaust connection

Part# Sitting Ht	Doors	Width (mm)
FA2500R	1 Right Hinged	517
FA2500L	1 Left Hinged	517
FA2600R	1 Right Hinged	600
FA2600L	1 Left Hinged	600
FA27502	2	750
FA21002	2	1000
FA21112	2	1117

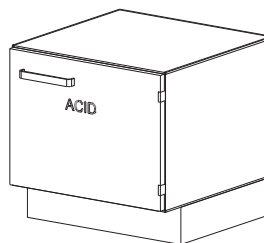

517/600mm

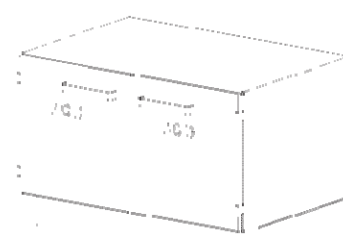

750/900/1000/1117/1200mm

For Solvent storage cabinets under fume hood, refer to Safety Cabinets section.

Wall Cabinets

Open

- Available in varying heights and 368mm depth
- 1 Adjustable Shelf in 450, 600, 768mm high cabinet
- 2 Adjustable shelves in 900, 1200mm high cabinet

Part# 450H	Part# 600H	Part# 768H	Part# 900H	Part# 1200H	Width (mm)
W104500	W204500	W304500	W404500	W504500	450
W105000	W205000	W305000	W405000	W505000	500
W106000	W206000	W306000	W406000	W506000	600
W107500	W207500	W307500	W407500	W507500	750
W109000	W209000	W309000	W409000	W509000	900
W110000	W210000	W310000	W410000	W510000	1000
W112000	W212000	W312000	W412000	W512000	1200

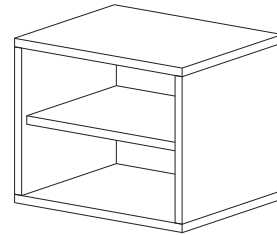

450/500/600mm

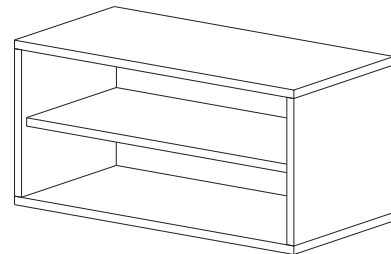

750/900/1000/1200mm

Solid Door

- Available in varying heights and 368mm depth
- 1 Adjustable Shelf in 450, 600, 768mm high cabinet
- 2 Adjustable shelves in 900, 1200mm high cabinet

Part# 450H	Part# 600H	Part# 768H	Part# 900H	Part# 1200H	Width (mm)
W10451R	W20451R	W30451R	W40451R	W50451R	450
W10451L	W20451L	W30451L	W40451L	W50451L	450
W10501R	W20501R	W30501R	W40501R	W50501R	500
W10501L	W20501L	W30501L	W40501L	W50501L	500
W10601R	W20601R	W30601R	W40601R	W50601R	600
W10601L	W20601L	W30601L	W40601L	W50601L	600
W107512	W207512	W307512	W407512	W507512	750
W109012	W209012	W309012	W409012	W509012	900
W110012	W210012	W310012	W410012	W510012	1000
W112012	W212012	W312012	W412012	W512012	1200

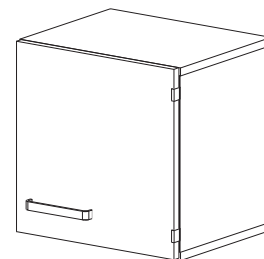

450/500/600mm

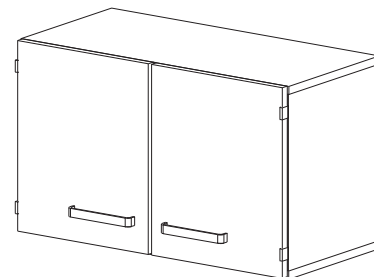

750/900/1000/1200mm

Wall Cabinets

Hinged Glass Door

- Available in varying heights and 368mm depth
- 1 Adjustable Shelf in 450, 600, 768mm high cabinet
- 2 Adjustable shelves in 900, 1200mm high cabinet

Part# 450H	Part# 600H	Part# 768H	Part# 900H	Part# 1200H	Width (mm)
W10452R	W20452R	W30452R	W40452R	W50452R	450
W10452L	W20452L	W30452L	W40452L	W50452L	450
W10502R	W20502R	W30502R	W40502R	W50502R	500
W10502L	W20502L	W30502L	W40502L	W50502L	500
W10602R	W20602R	W30602R	W40602R	W50602R	600
W10602L	W20602L	W30602L	W40602L	W50602L	600
W107522	W207522	W307522	W407522	W507522	750
W109022	W209022	W309022	W409022	W509022	900
W110022	W210022	W310022	W410022	W510022	1000
W112022	W212022	W312022	W412022	W512022	1200

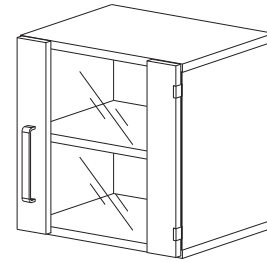

450/500/600mm

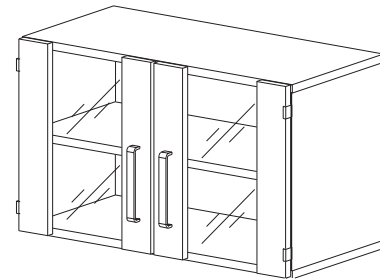

750/900/1000/1200mm

Sliding Glass Door

- Available in varying heights and 368mm depth
- 1 Adjustable Shelf in 450, 600, 768mm high cabinets
- 2 Adjustable shelves in 900, 1200mm high cabinets

Part# 450H	Part# 600H	Part# 768H	Part# 900H	Part# 1200H	Width (mm)
W107532	W207532	W307532	W407532	W507532	750
W109032	W209032	W309032	W409032	W509032	900
W110032	W210032	W310032	W410032	W510032	1000
W112032	W212032	W312032	W412032	W512032	1200

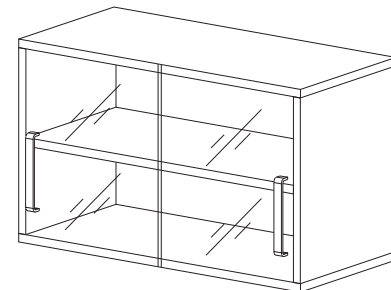

750/900/1000/1200mm

Tall Storage Cabinets

Open

- Available in 368mm and 560mm Depths
- 1980mm Height
- 4 Adjustable Shelves

Part# 368D	Part# 560D	Doors	Width (mm)
T104500	T204500	-	450
T105000	T205000	-	500
T106000	T206000	-	600
T107500	T207500	-	750
T101000	T201000	-	1000
T101200	T201200	-	1200

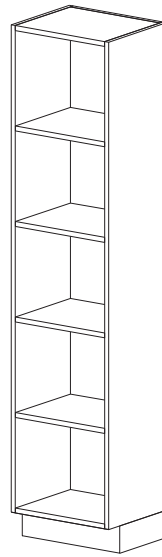

450/500/600mm

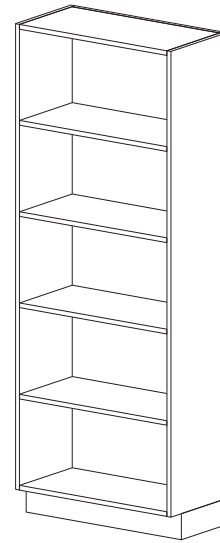

750/900/1000/1200mm

Solid Door

- Available in 368mm and 560mm Depths
- 1980mm Height
- Solid hinged door(s)
- 4 Adjustable Shelves

Part# 368D	Part# 560D	Doors	Width (mm)
T10451R	T20451R	1 Right Hinged	450
T10451L	T20451L	1 Left Hinged	450
T10501R	T20501R	1 Right Hinged	500
T10501L	T20501L	1 Left Hinged	500
T10601R	T20601R	1 Right Hinged	600
T10601L	T20601L	1 Left Hinged	600
T107512	T207510	2	750
T109012	T209012	2	900
T110012	T210012	2	1000
T112012	T212012	2	1200

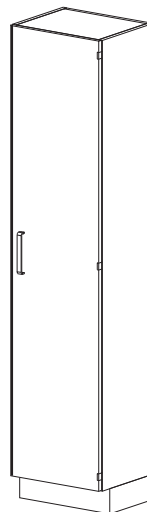

450/500/600mm

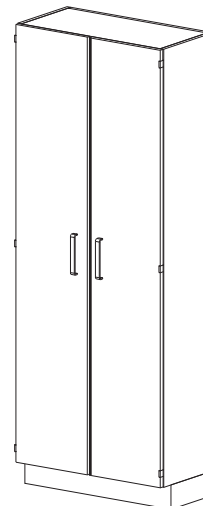

750/900/1000/1200mm

Tall Storage Cabinets

Hinged Glass Door

- Available in 368mm and 560mm Depths
- 1980mm Height
- 4 Adjustable Shelves
- Hinged glass door(s)

Part# 368D	Part# 560D	Doors	Width (mm)
T10452R	T20452R	1 Right Hinged	450
T10452L	T20452L	1 Left Hinged	450
T10502R	T20502R	1 Right Hinged	500
T10502L	T20502L	1 Left Hinged	500
T10602R	T20602R	1 Right Hinged	600
T10602L	T20602L	1 Left Hinged	600
T107522	T207522	2	750
T109022	T209022	2	900
T110022	T210022	2	1000
T112022	T212022	2	1200

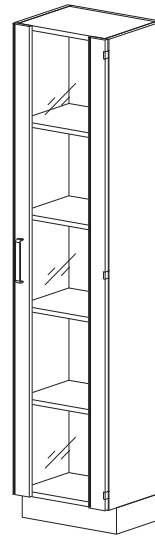

450/500/600mm

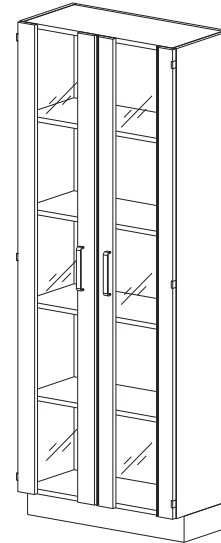

750/900/1000/1200mm

Framed Solid/Glass Door

- Available in 368mm and 560mm Depths
- 1980mm Height
- Framed solid/glass door(s)
- 4 Adjustable Shelves

Part# 368D	Part# 560D	Doors	Width (mm)
T10453R	T20453R	1 Right Hinged	450
T10453L	T20453L	1 Left Hinged	450
T10503R	T20503R	1 Right Hinged	500
T10503L	T20503L	1 Left Hinged	500
T10603R	T20603R	1 Right Hinged	600
T10603L	T20603L	1 Left Hinged	600
T107532	T207530	2	750
T109032	T209032	2	900
T110032	T210032	2	1000
T112032	T212032	2	1200

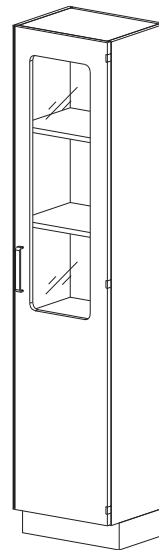

450/500/600mm

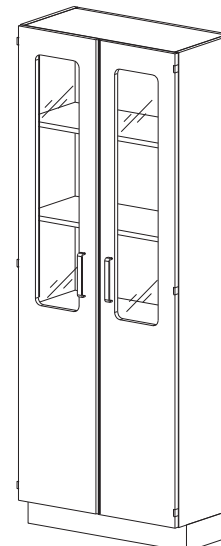

750/900/1000/1200mm

Panels

Knee Space

- 890mm Standing Height
- 730mm Sitting Height
- PVC edging on all sides

Part# (Standing HT)	Part# (Sitting HT)	Width (mm)
K106000	K206000	600
K107500	K207500	750
K109000	K209000	900
K110000	K210000	1000
K112000	K212000	1200

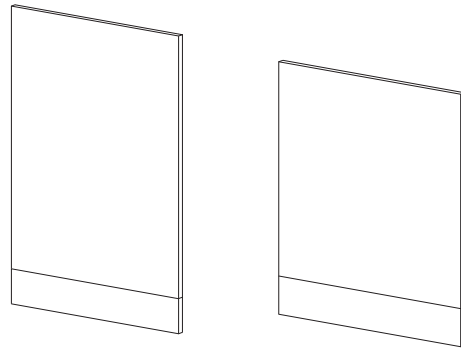

Side Panels/Back Panels

- 785mm Standing Height
- 625mm Sitting Height
- PVC Edging on all sides

Part# (Standing HT)	Part# (Sitting HT)	Width (mm)
P10560S	P20560S	560
P10710S	P20710S	710
P10860S	P20860S	860
P11000S	P21000S	1000
P11200S	P21200S	1200

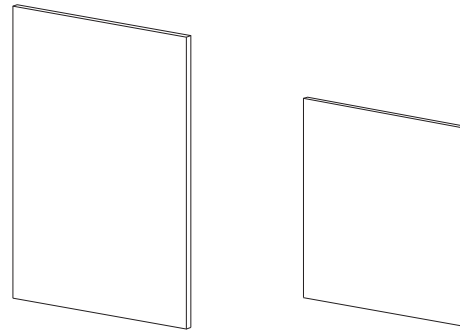

Front Panels

- 890mm Standing Height
- 730mm Sitting Height
- PVC edging on all sides

Part# (Standing HT)	Part# (Sitting HT)	Width (mm)
P10080F	P20080F	80
P10150F	P20150F	150
P10300F	P20300F	300
P10450F	P20450F	450
P10600F	P20600F	600

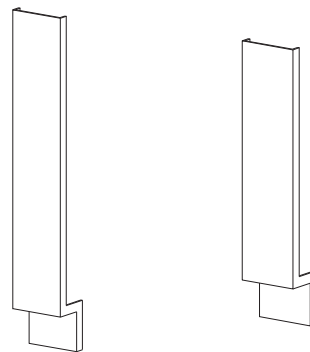

Corner Panels

- 890mm Standing Height
- 730mm Sitting Height
- PVC Edging on all sides

Part# (Standing HT)	Part# (Sitting HT)	Width (mm)
P10150C	P20150C	150
P10300C	P20300C	300

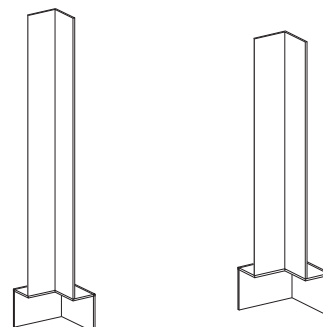

UTILITY SPINE

By combining a utility spine and laboratory workbenches, you can create a wall workbench or island workbench solution. The utility spine serves as a supply module, providing all the required supply and discharge lines as well as electric services via the electrical conduit. The utility spine consists of two support beams with adjustable feet, a sink panel with integrated drip cup, splash guard, reagent shelving and system shelves.

If laboratory planning divides the available space into 600, 900, 1200 or 1500 mm units, you can make use of our new, specially developed modular service spine. As opposed to the regular system, each modular service spine unit has two functional stands. They consist of a 60 x 20 mm steel profile with 35 mm vertical slots that serve to attach system shelves, reagent shelves or other additional items.

In order to isolate the service spine from the furniture as such, the cup sink is mounted to the spine's service supply cover.

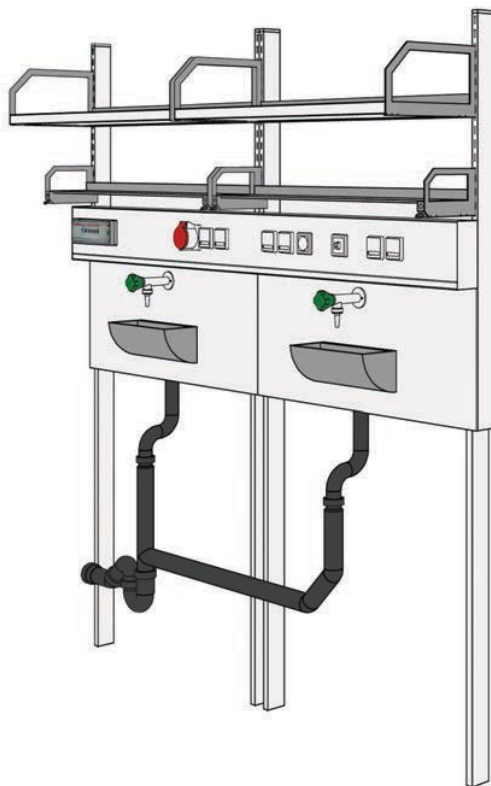

Wall Bench Utility Spine with shelves and services

Utility Spine - Wall Assembly

- Modular design available in 600, 900, 1200, 1500 and 1800mm widths
- 1970mm Height, extendable
- Each spine has two powder coated aluminum vertical stands
- Add-on functional elements include shelves, vertical panels, electrical raceway, light fixture, water/gas taps, cupsink

Part#	Width (mm)
U060000	600
U090000	900
U012000	1200
U015000	1500
U018000	1800

Add-on elements (for wall assembly)

Vertical Panel	Regent Shelf	System Shelf	Electrical Raceway
U16000P	U16000R	U16000S	U16000E
U19000P	U19000R	U19000S	U19000E
U11200P	U11200R	U11200S	U11200E
U11500P	U11500R	U11500S	U11500E
U11800P	U11800R	U11800S	U11800E

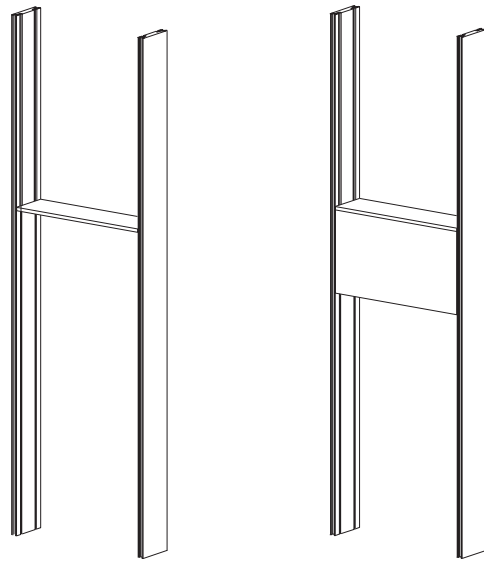

U060000

U060000 with U16000P

Refer to Service Fixture section of catalogue for adding electrical fixtures, water taps, gas fitting, cupsink, shelf light, etc.

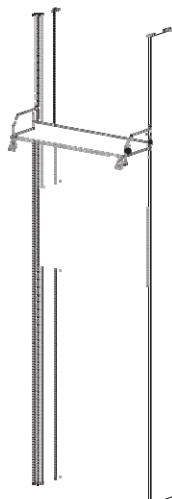

U060000 with
U16000P, U16000R

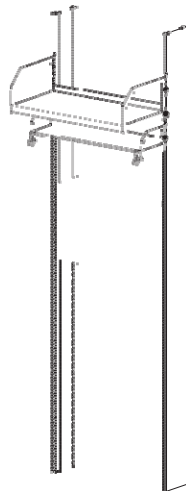

U060000 with
U16000P, U16000R, U16000S

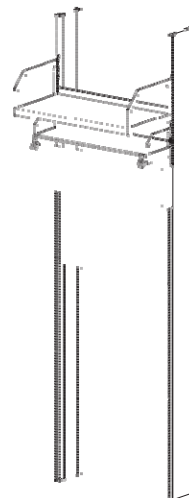

U060000 with
U16000P, U16000R, U16000S, U16000E

Utility Spine-Island Assembly

- Modular design available in 600, 900, 1200, 1500 and 1800mm widths
- 1970mm Height, extendable
- Each spine has two powder coated aluminum vertical stands
- Add-on functional elements include shelves, vertical panels, electrical raceway, light fixture, water/gas taps, cupsink

Part#	Width (mm)
U060000	600
U090000	900
U012000	1200
U015000	1500
U018000	1800

Add-on elements (for island assembly)

Vertical Panel	Regent Shelf	System Shelf	Electrical Raceway	Acrylic Partition
U26000P	U26000R	U26000S	U26000E	U26000A
U29000P	U29000R	U29000S	U29000E	U29000A
U21200P	U21200R	U21200S	U21200E	U21200A
U21500P	U21500R	U21500S	U21500E	U21500A
U21800P	U21800R	U21800S	U21800E	U21800A

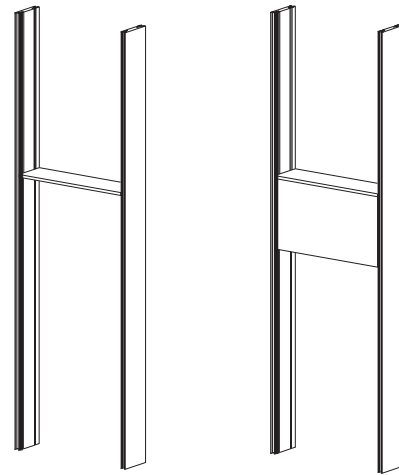

U060000

U060000 with U26000P

Refer to Service Fixture section of catalogue for adding electrical fixtures, water taps, gas fitting, cupsink, shelf light, etc.

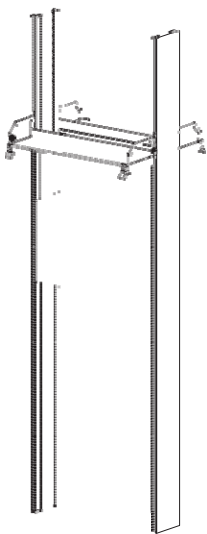

U060000 with U26000P, U26000R

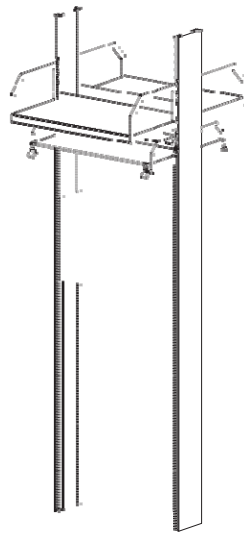

U060000 with U26000P, U26000R, U26000S, U26000E

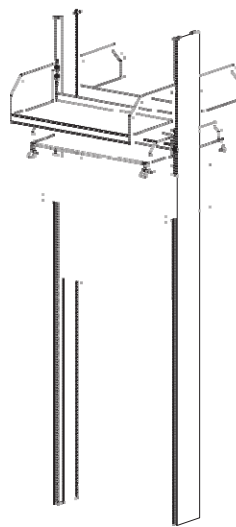

U060000 with U26000P, U26000R, U26000S, U26000E

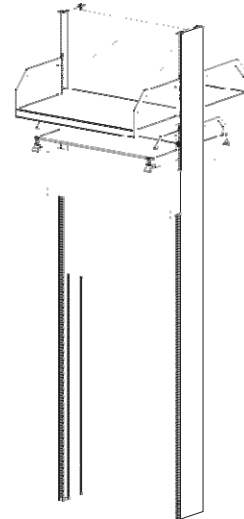

U060000 with U26000P, U26000R, U26000S, U26000E, U26000A

Overhead Service Spine

- Available in 600, 900, 1200 and 1500mm widths
- Mounted to ceiling with brackets
- Custom lengths available
- Add-on functional elements include electrical raceway, light fixture, plumbing, extraction arm

Part#	Width (mm)
O060000	600
O090000	900
O012000	1200
O015000	1500

Refer to Service Fixture section of catalogue

for adding electrical fixtures, valves/gas fitting, light, extraction arm, etc.

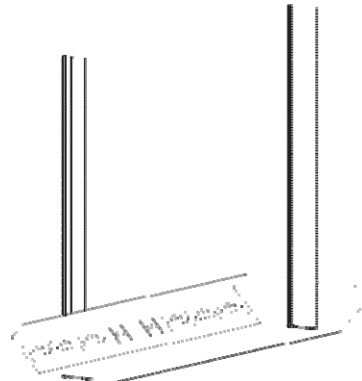

O012000

Service Drop

- Available in various heights
- For Wall and Island benches
- Hinged access panel
- Suitable for passing utility and electrical connections from above false ceiling to bench.

Part#	Width (mm)	Height(mm)
SD03001	300	2100
SD03002	300	2250
SD06001	600	2100
SD06002	600	2250

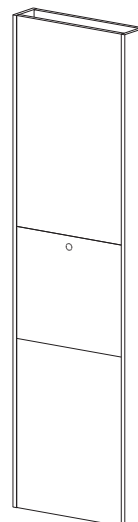

SD06001

FRAMES & TABLES

C-Frame

- Modular design available in 600, 900, 1200, 1500 and 1800mm widths.
- 890mm Standing Height, 730mm Sitting Height
- 750mm Depth
- Frame includes legs, back panel, front and back rails.

Part# (Standing HT)	Part# (Sitting HT)	Width (mm)
CF10060	CF20060	600
CF10090	CF20090	900
CF10120	CF20120	1200
CF10150	CF20150	1500
CF10180	CF20180	1800

Refer to Mobile and Hanging Cabinets section of catalogue for adding cabinets to C-frame.

Refer to Worksurface section of catalogue for adding worktop.

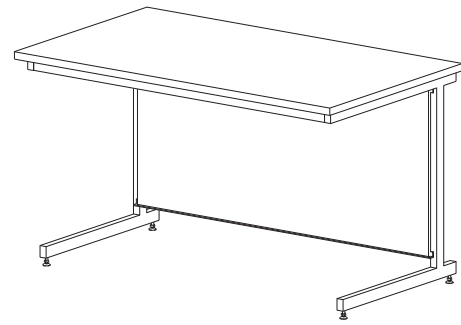

C-FRAME TABLE

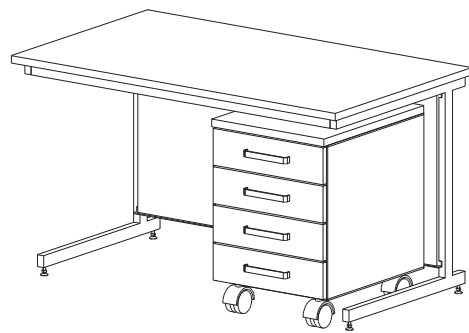

C-FRAME TABLE WITH MOBILE CABINET

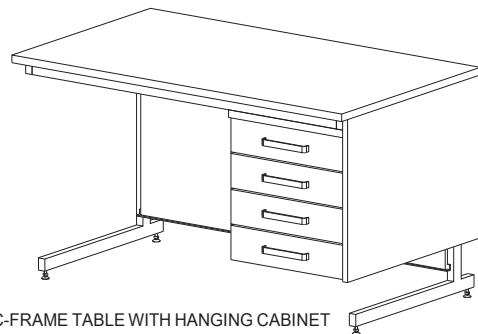

C-FRAME TABLE WITH HANGING CABINET



H-Frame

- Modular design available in 600, 900, 1200, 1500 and 1800mm widths.
- 890mm Standing Height, 730mm Sitting Height
- 750mm Depth
- Frames includes legs, back panel, front and back rail

Part# (Standing HT)	Part# (Sitting HT)	Width (mm)
HF10060	HF20060	600
HF10090	HF20090	900
HF10120	HF20120	1200
HF10150	HF20150	1500
HF10180	HF20180	1800

Refer to Mobile and Hanging Cabinets section of catalogue for adding cabinets to H-frame.

Refer to Worksurface section of catalogue for adding worktop.

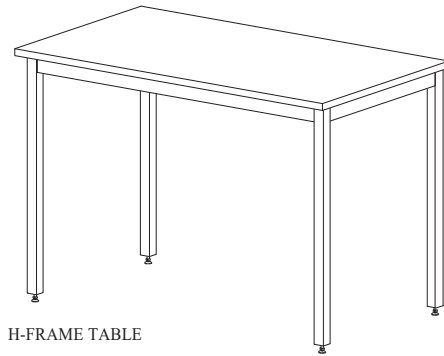

H-FRAME TABLE



H-FRAME TABLE WITH MOBILE CABINET

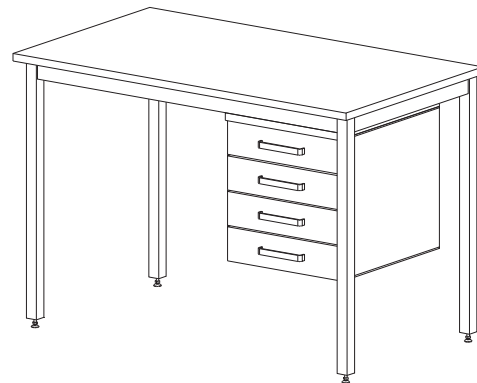

H-FRAME TABLE WITH HANGING CABINET

C-Frame - Heavy Duty

- Powder coated steel, heavy duty tubular construction
- 882mm Standing Height, 730mm Sitting Height
- 750mm Single sided Depth, 1500mm Double sided Depth

- Fully welded legs with levelling feet
- Worktop not included

		Part#	Part#
		(Standing HT)	(Sitting HT)
Leg Single Sided	Left Leg	CHD101L	CHD201L
	Right Leg	CHD101R	CHD201R
	Middle Leg	CHD101M	CHD201M
	Service Leg	CHD101S	CHD201S

		Part#	Part#
		(Standing HT)	(Sitting HT)
Leg Double Sided	Left Leg	CHD102L	CHD202L
	Right Leg	CHD102R	CHD202R
	Middle Leg	CHD102M	CHD202M

	Part#	Part#	Width
	(Single S)	(Double S)	(mm)
Stretchers	CSS1060	CSS2060	600
	CSS1075	CSS2075	750
	CSS1090	CSS2090	900
	CSS1100	CSS2100	1000
	CSS1120	CSS2120	1200
	CSS1150	CSS2150	1500
	CSS1180	CSS2180	1800

	Part#	Part#	Width
	(Standing HT)	(Sitting HT)	(mm)
Modesty Panel	CMP1060	CMP2060	600
	CMP1075	CMP2075	750
	CMP1090	CMP2090	900
	CMP1100	CMP2100	1000
	CMP1120	CMP2120	1200
	CMP1150	CMP2150	1500
	CMP1180	CMP2180	1800

	Part#	Part#	Width
	(Standing HT)	(Sitting HT)	(mm)
Back Panel	CBP1060	CBP2060	600
	CBP1075	CBP2075	750
	CBP1090	CBP2090	900
	CBP1100	CBP2100	1000
	CBP1120	CBP2120	1200
	CBP1150	CBP2150	1500
	CBP1180	CBP2180	1800

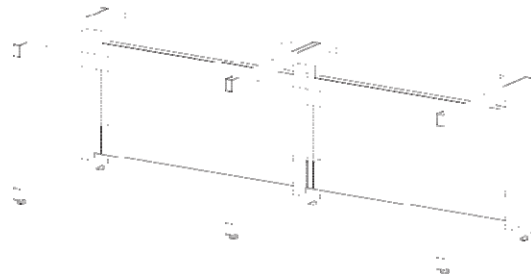

HEAVY DUTY C-FRAME WITH LEFT, MIDDLE AND RIGHT LEG

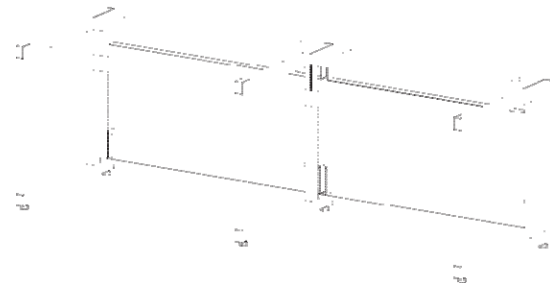

HEAVY DUTY C-FRAME WITH LEFT, SERVICE AND RIGHT LEG

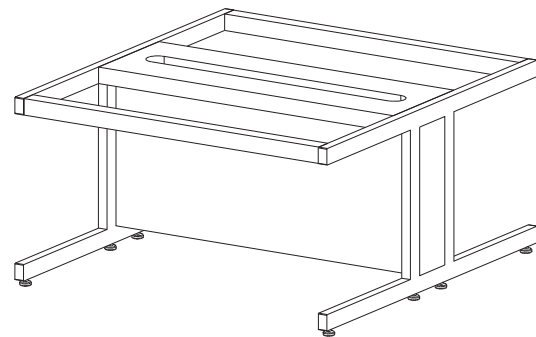

HEAVY DUTY DOUBLE SIDED C-FRAME WITH MODESTY PANEL

Refer to Mobile and Hanging Cabinets section of catalogue for adding cabinets to C-frame.

Refer to Worksurface section of catalogue for adding worktop.

Mobile Table / Trolley

- Modular design available in 600, 900, 1200, 1500 and 1800mm widths.
- 890mm Standing Height, 730mm Sitting Height
- 750mm Depth
- Optional shelves, electrical trunking.
- Frame includes legs with lockable castors, front and back rail
- Worktop not included

Part# (Standing HT)	Part# (Sitting HT)	Width (mm)
MTA1060	MTA2060	600
MTA1090	MTA2090	900
MTA1120	MTA2120	1200
MTA1150	MTA2150	1500
MTA1180	MTA2180	1800

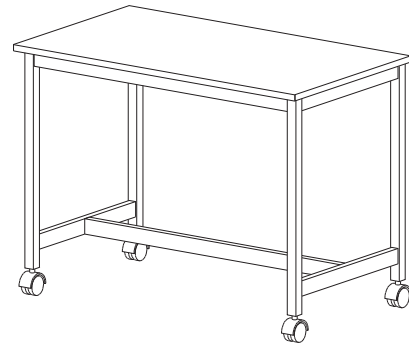

MTA1120 WITH WORKTOP

Refer to Mobile and Hanging Cabinets section of catalogue for adding cabinets to Mobile Tables.

Refer to Worksurface section of catalogue for adding worktop.



Stainless Steel Table

- 890mm Standing Height, 730mm Sitting Height
- Overall depth 610mm or 762mm.
- Table made of stainless steel legs, 16 gauge, type 304 Stainless Steel.
- Stainless steel work top and adjustable shelf included.

Part# (Standing HT)	Part# (Sitting HT)	Width (mm)	Depth (mm)
STA1030	STA2030	762	610
STA1036	STA2036	914	610
STA1048	STA2048	1219	610
STA1060	STA2060	1524	610
STA1072	STA2072	1829	610
STA1130	STA2130	762	762
STA1136	STA2136	914	762
STA1148	STA2148	1219	762
STA1160	STA2160	1524	762
STA1172	STA2172	1829	762

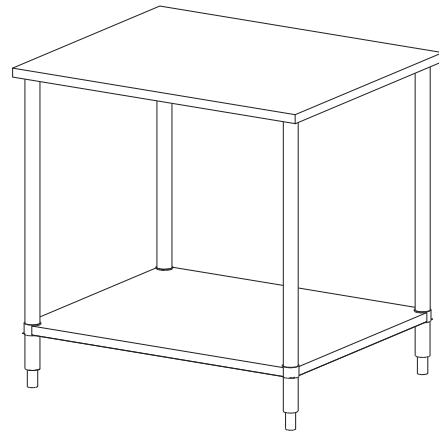

STA1030

Crank Operated Table

- Crank-operated height adjustability from 730mm to 890mm.
- 762mm Depth
- Worktop not included.

Part# (mm)	Width (mm)
ACC2136	914
ACC2148	1219
ACC2160	1524
ACC2172	1829

Refer to Worksurface section of catalogue for adding worktop.

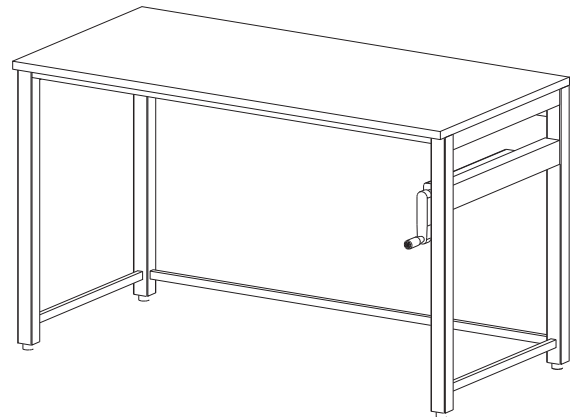

ACC2148 WITH WORKTOP

Vibration Isolation Table

- 890mm Standing Height, 730mm Sitting Height
- 762mm Depth
- Vibration Isolation Table is designed to provide stable working conditions for devices that are sensitive to vibration and shocks.
- Table consists of outer table frame that supports work surface that is not isolated from vibration and an inner table frame that is entirely separate and supports the inner isolated work surface. This ensures vibrations are not transmitted to the isolated inner work surface.
- Isolated platform is consists of a steel tray that is to be filled with sand or concrete (not included).
- Platform is supported by four rubber shock absorbing isolators.
- Worktop not included.

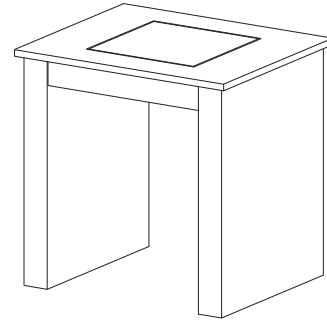

VIT1236

Part# (Standing HT)	Part# (Sitting HT)	Width (mm)
VIT1236	VIT2236	914
VIT1242	VIT2242	1067
VIT1248	VIT2248	1219
STA1150	STA2150	1524
STA1180	STA2180	1829

Refer to Worksurface section of catalogue for adding worktop.

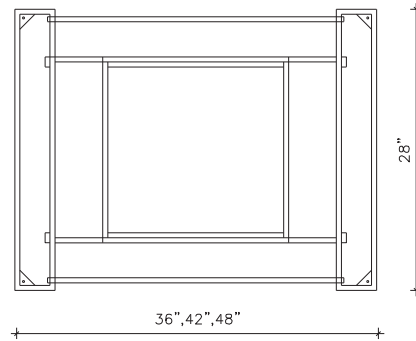

TOP VIEW OF TABLE FRAME

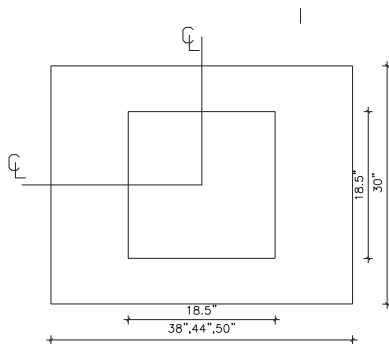

TYPICAL NON-ISOLATED WORKSURFACE

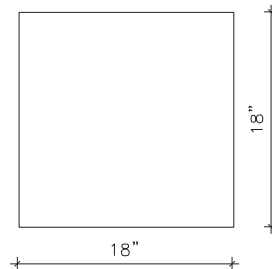

TYPICAL INNER ISOLATED WORKSURFACE

FUME HOODS

Fume cupboards are central components in laboratories, and we have a variety of cupboard types manufactured by Laboratory Solutions FZC, to suit different applications. These applications place increasingly high demands on the equipment as more and more laboratory tasks need to be performed in a fume hood due to the rising numbers of hazardous substances and reagents. Engineering regulation EN 14175 has also set significantly stricter standards.

We provide fume cupboards with standard widths of 1200, 1500, 1800 and 2100 mm. But of course we also provide solutions tailored to your specific needs. To cater for a broad range of applications, we have bench-top fume cupboards, fume cupboards for low rooms or with extra interior height and walk-in fume cupboards. Worktops and interior linings are configured according to the type of tasks to be performed, the gases and liquids used, the vapours and aerosols emitted.



Monitoring and control

The fume cupboard, air flow monitoring and control system, room air management and ventilation system are one interactive system. In order to set up the optimal interface parameters, a governing overall concept is needed. This is the only way of safely operating a fume cupboard.

In compliance with this aero-technological overall concept, fume cupboards are equipped with air flow controls according to EN 14175 Part 2 or with a constant or variable volume control system (VAV). Options include the implementation of an automatically closing front sash. In combination with a variable volume control system that is connected to the front sash, the exhaust air volume can be drastically reduced

controls according to EN 14175 Part 2 or with a constant or variable volume control system (VAV). Options include the implementation of an automatically closing front sash. In combination with a variable volume control system that is connected to the front sash, the exhaust air volume can be drastically reduced.

Fume cupboard with Fire Extinguishing System (FES)

FES fume cupboards feature a safety system for preventing fires. These fume cupboards feature an automated fire prevention system, thus allowing for 24-hour or unattended operation. The combination of fume cupboard and fire extinguishing system guarantees round-the-clock safety.

The FES system includes a compressed gas generator, thermal and/or optical (UV) fire detector, control devices, optical and acoustic warning devices as well as a push-button for manual activation. In the event of fire, the front sash is closed and exhaust damper and media supply are shut off. The compressed gas generator is started, argon gas is released via the distribution rail to flood and immediately extinguish the fire. At the same time, acoustic and optical warning signals are triggered, and information is passed on to the in-house building management system and the fire brigade.

Special fume cupboards according to DIN 12924 - Part 2

Special application fume cupboards according to DIN 12924 Part 2 are used for open dissociation processes. These fume cupboards feature ceramic or polypropylene lining and are fitted with a main exhaust duct. They are used when working with aggressive media such as sulphuric acid, perchloric acid, hydrofluoric acid or aqua regia. Fume cupboards



can be fitted with a gas scrubber to prevent harmful gases leaking into the atmosphere. The absorption device operates in fully automatically. The scrubbing fluid is filled and refilled via a fluid level monitor. The electrical conductivity of the fluid is continuously monitored. Additionally, the system can be augmented by installing a waste water neutralisation unit in the base cabinet to neutralise acidic or alkaline waste waters.

Radioisotope and filter fume cupboards according to DIN 25466

Radioisotope fume cupboards are designed according to the specifications of DIN 25466, fully compliant with the strict regulations on radiation protection. Interior lining and worktop are made of stainless steel or polypropylene. The upper section of the cupboard contains a two-stage filter unit (pre-filter, particle filter). These cupboards can also be equipped with four-fold filtering, consisting of a pre-filter, particle filter, carbon and abraded matter by adding a laterally mounted element.

Bench Mounted Fume Hoods to EN 14175

By definition, the purpose of a fume cupboard is to prevent gases, fumes or suspended matter from escaping into the laboratory by means of specific design features and air ducts. They are also intended to prevent a dangerous explosive atmosphere in the laboratory, and the front sash protects laboratory staff against a spill of a harmful substance or flying debris or glass splinters. Our proven designs comply with all these demands and ensure maximum safety in the laboratory.

The standard fume cupboard features melamine interior lining, ceramic worktop, stand mounts and lighting. Electric sockets and services (water, gases, pure gases) are installed according to your needs, and base cabinets can be combined as required.

Interior lining

- Melamine
- Polypropylene
- Stainless steel
- Stoneware (Ceramic)
- Phenolic Resin



Benchtop Fume Hood with Melamine front panel

Technical data

Width	1200	1500	1800	2100
External dimensions	1200 x 945 x 2748	1500 x 945 x 2748	1800 x 945 x 2748	2100 x 945 x 2748
Internal workspace 1	1160 x 740 x 1050	1460 x 740 x 1050	1760 x 740 x 1050	2060 x 740 x 1050
Internal workspace 2	1160 x 740 x 1530	1460 x 740 x 1530	1760 x 740 x 1530	2060 x 740 x 1530
Recommended volumetric exhaust flow (m ³ /h)	400	530	660	790
Recommended volumetric exhaust flow (m ³ /h) with supportive air flow technology	350	450	560	680

Good visibility even in the upper part of a fume cupboard is particularly important for tall test set-ups. This model features a frame with two laterally sliding safety glass windows instead of a solid front panel, enabling easy reach into the upper part of the fume cupboard.

If the focus is primarily on visibility and easy reach into the upper part of the cupboard is less important, this cost-saving solution is equipped with fixed upper front glazing.

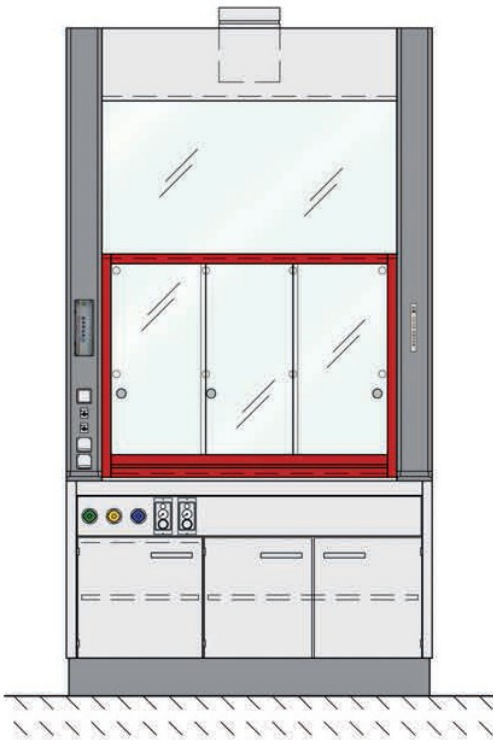

Fume Hood with front Sliding safety glass

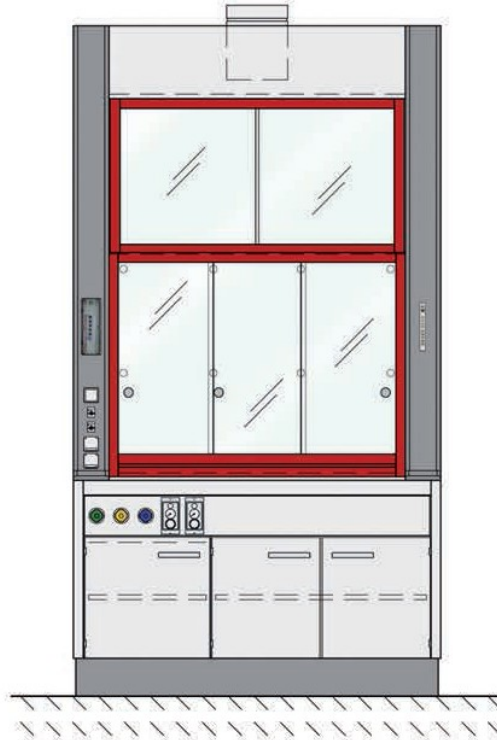

Fume Hood with front fixed safety

Bench Mounted Fume Hood Models

Interior Lining Material	Part# 1200W	Part# 1500W	Part# 1800W	Part# 2100W
Melamine	FB12011	FB15011	FB18011	FB21011
Polypropylene	FB12012	FB15012	FB18012	FB21012
Stainless Steel	FB12013	FB15013	FB18013	FB21013
Stoneware (Ceramic)	FB12014	FB15014	FB18014	FB21014
Phenolic Resin	FB12015	FB15015	FB18015	FB21015

*Change second last digit for selecting top front panel:

- Melamine (standard) 1
- Sliding Safety Glass 2
- Fixed Safety Glass 3

Fume Hoods for low rooms according to EN 14175

Laboratories normally provide clear heights of at least 3 m. If, however, rooms are lower, standard fume cupboards with structural heights of 2738 mm cannot be installed and special fume cupboards for low rooms must be used.

Owing to a separated front sash (twin-sash), which does not extend beyond the fume cupboard's structural height, these fume cupboards have a height of 2400 mm.

The side walls of all fume cupboards can be fitted with flap gates to allow for lateral introduction of cables, tubes or pipes into the fume cupboard.



Bench Mounted Fume Hood Models for Low Rooms

Interior Lining Material	Part# 1200W	Part# 1500W	Part# 1800W	Part# 2100W
Melamine	FL12001	FL15001	FL18001	FL21001
Polypropylene	FL12002	FL15002	FL18002	FL21002
Stainless Steel	FL12003	FL15003	FL18003	FL21003
Stoneware (Ceramic)	FL12004	FL15004	FL18004	FL21004
Phenolic Resin	FL12005	FL15005	FL18005	FL21005

Technical data

Width	1200	1500	1800	2100
External dimensions	1200 x 930 x 2400	1500 x 930 x 2400	1800 x 930 x 2400	2100 x 930 x 2400
Internal workspace	1160 x 740 x 1050	1460 x 740 x 1050	1760 x 740 x 1050	2060 x 740 x 1050
Recommended volumetric exhaust flow (m ³ /h)	400	530	660	790
Recommended volumetric exhaust flow (m ³ /h) with supportive air flow technology	350	450	560	680

Distillation Fume Hoods according to EN 14175

High-rising test set-ups require special fume cupboard designs. That is why the worktops of our low-level fume cupboards are mounted at a height of 500 mm. This provides for a clear interior height of 1940 mm. The front sash consists of two separate elements.

As with all fume hoods, a sturdy steel frame provides the supporting structure for the fume cupboard superstructure. All fume cupboards can be fitted with composite safety glazing in the side in order to ensure good visibility into the cupboard's interior.



Bench Mounted Fume Hood Models for Low Rooms

Interior Lining Material	Part# 1200W	Part# 1500W	Part# 1800W	Part# 2100W
Melamine	FD12001	FD15001	FD18001	FD21001
Polypropylene	FD12002	FD15002	FD18002	FD21002
Stainless Steel	FD12003	FD15003	FD18003	FD21003
Stoneware (Ceramic)	FD12004	FD15004	FD18004	FD21004
Phenolic Resin	FD12005	FD15005	FD18005	FD21005

Technical data

Width	1200	1500	1800	2100
External dimensions	1200 x 945 x 2748	1500 x 945 x 2748	1800 x 945 x 2748	2100 x 945 x 2748
Internal workspace	1160 x 740 x 1940	1460 x 740 x 1940	1760 x 740 x 1940	2060 x 740 x 1940
Recommended volumetric exhaust flow (m ³ /h)	500	630	760	890
Recommended volumetric exhaust flow (m ³ /h) with supportive air flow technology	450	550	660	780

Walk-in Fume Hoods according to EN 14175

Walk-in fume cupboards are required when test set-ups are prepared on trolleys and moved into the fume cupboard. Also, an interior clear height of 2400 mm allows for particularly tall test set-ups.

The sink is placed into a lateral board, and taps and fixtures are also mounted on the side wall. Electric energy is supplied via pylons and can be installed on either side. As with all our other fume hood models, electrical sockets can also be installed inside the cupboard.

Interior lining

- Melamine
- Polypropylene
- Stainless Steel
- Stoneware (Ceramic)
- Phenolic Resin



Walk-in Fume Hood with Melamine front panel

Technical data

Width	1200	1500	1800	2100
External dimensions	1200 x 945 x 2748	1500 x 945 x 2748	1800 x 945 x 2748	2100 x 945 x 2748
Internal workspace	1160 x 740 x 2400	1460 x 740 x 2400	1760 x 740 x 2400	2060 x 740 x 2400
Recommended volumetric exhaust flow (m ³ /h)	600	730	860	990

Good visibility into the fume cupboard chamber is essential, particularly when working with tall test set-ups. This model has two laterally sliding windows instead of a solid front panel, so that personnel can easily reach into the upper part of the fume cupboard.

If the focus is primarily on visibility and being able to reach into the upper part of the cupboard is of secondary importance, this solution with fixed glazing is the economical solution.

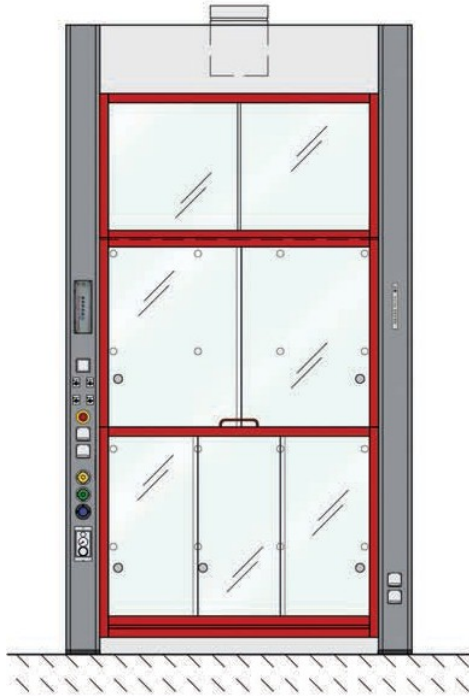

Fume Hood with front Sliding safety glass

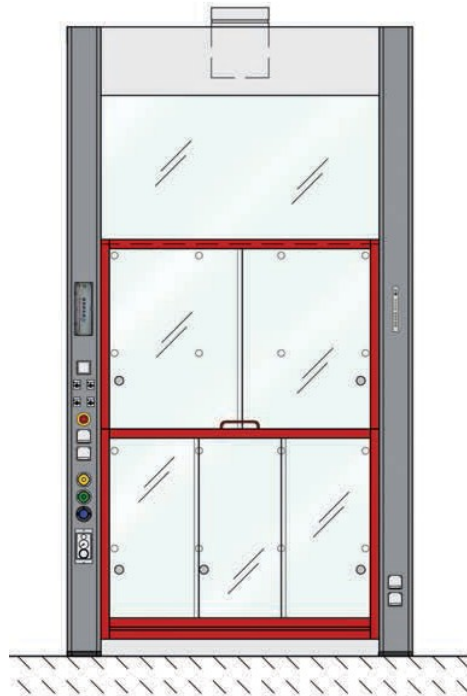

Fume Hood with front Fixed safety glass

Walk-in Fume Hood Models

Interior Lining Material	Part# 1200W	Part# 1500W	Part# 1800W	Part# 2100W
Melamine	FW12011	FW15011	FW18011	FW21011
Polypropylene	FW12012	FW15012	FW18012	FW21012
Stainless Steel	FW12013	FW15013	FW18013	FW21013
Stoneware (Ceramic)	FW12014	FW15014	FW18014	FW21014
Phenolic Resin	FW12015	FW15015	FW18015	FW21015

**Change second last digit for selecting top front panel:*

- Melamine (standard) 1
- Sliding Safety Glass 2
- Fixed Safety Glass 3

METAL FUME HOODS

Fume Hoods tested to ASHRAE 110 standards

Steel fume hoods offered by Laboratory Solutions are made by Mott Manufacturing Ltd. Canada.

Mott's fume hoods have been specifically developed to meet the demanding safety, energy conservation, and operational requirements of the modern laboratory. All fume hoods are designed using proven aerodynamic and ventilation concepts. They are then manufactured to exacting standards and tested to accepted protocols (ASHRAE 110).

Our attention to detail has allowed Mott's fume hoods to earn a reputation as an industry leader in reliable containment performance and contemporary aesthetic design.

Available in numerous models, Mott's fume hoods can be readily custom manufactured through the integration of an extensive offering of optional features. The resulting adaptability delivers effective safety and operational solutions for the many varied application demands found in laboratories today.

Mott is ISO certified and member of SEFA. Mott products are SEFA certified.



Standard Pro Bench Series Fume Hoods

This all purpose fume hood is designed to meet most laboratory Constant Air Volume (CAV) or Variable Air Volume (VAV) requirements.

Pro series bench mounted fume hood is supplied with following standard features:

- A vertical rising sash.
- An automatic compensating upper by-pass .
- Field-convertible to Restricted By-Pass for VAV use.
- A lower airfoil by-pass with electrical cord notches.
- Cable or Chain/Sprocket Sash System.
- A UL/CSA approved fluorescent light fixture
- Both corner posts pre-punched to accept a maximum of 5 plumbing fittings per post.
- Standard FRP liner.
- Removable interior access panel in each side wall.
- Removable exterior side panels.
- Several liner materials are available.
- Available in either stainless steel cable, or chain and sprocket sash suspension system.

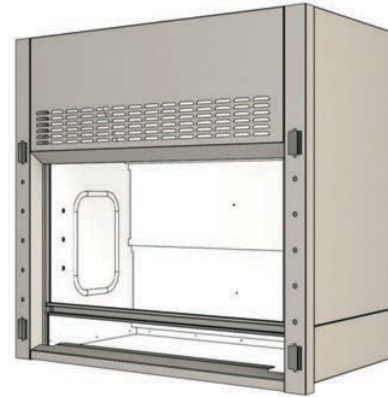

Fume Hood with Vertical Sash

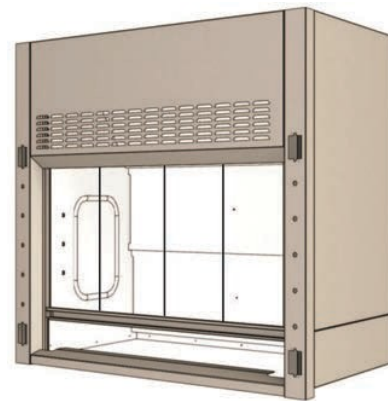

Fume Hood with Combination Sash

Optional Features:

- Stainless, Epoxy, PVC liners
- Automatic Sash Mechanism
- Vision Panel
- Flush Sill Airfoil
- Distillation rack
- Base cabinet and stands

Pro Bench Top Fume Hoods

Sash System	Vertical Sash				Combination Sash			
	Cable & Pulley		Chain & Sprocket		Cable & Pulley		Chain & Sprocket	
<i>Linear Material</i>	<i>FRP</i>	<i>SS</i>	<i>FRP</i>	<i>SS</i>	<i>FRP</i>	<i>SS</i>	<i>FRP</i>	<i>SS</i>
914mm	7121000	7124000	7121040	7124040	--	--	--	--
1219mm	7221000	7224000	7221040	7224040	7221010	7224010	7221050	7224050
1524mm	7321000	7324000	7321040	7324040	7321010	7324010	7321050	7324050
1829mm	7421000	7424000	7421040	7424040	7421010	7424010	7421050	7424050
2438mm	7521000	7524000	7521040	7524040	7521010	7524010	7521050	7524050
1000mm	7B21000	7B24000	7B21040	7B24040	--	--	--	--
1500mm	7C21000	7C24000	7C21040	7C24040	7C21010	7C24010	7C21050	7C24050
2000mm	7D21000	7D24000	7D21040	7D24040	7D21010	7D24010	7D21050	7D24050

*SS liner type 316 with Square corners.

*Contact Laboratory Solutions for exhaust parameters.

SafeGuard Bench Top Fume Hoods

The SafeGuard™ fume hood represents a balance of key safety elements and new design. The SafeGuard™ Constant Air Volume (CAV) fume hood has been developed to meet the challenging safety, energy conservation, and operational requirements of today's laboratory. The new contemporary design creates a stylish image for today's modern lab environment.

The SafeGuard bench mounted fume hood is supplied with the following standard features:

- Vertical or Combination rising sash.
- Chain and sprocket sash counterbalance system.
- Field covertable for VAV use.
- Low profile powder coated, type 316 stainless steel hinged airfoil is flush with work surface to for easy cleaning.
- The airfoil allows for the safe introduction of electrical wiring into the fume hood in a manner that still allows the full closure of the sash.
- 34" high sash glass allows for superior visibility of the fume hood interior.
- UL/CSA approved fluorescent light fixture.
- Two corner posts pre-punched to accept a maximum of 4 plumbing fittings per post.
- Removable interior access panels.
- Removable exterior side panels.
- Auto sash leveler automatically closes to the 18" height which decreases exhaust air and offers extra protection to the operator.
- Round exhaust collar.

Optional Features:

- Stainless, Epoxy, PVC liners
- Automatic Sash Mechanism
- Vision Panel
- Flush Sill Airfoil
- Distillation rack
- Base cabinet and stands

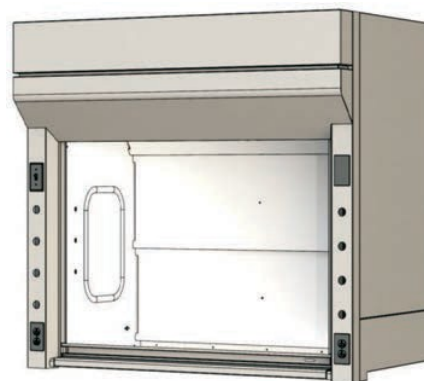

Fume Hood with Vertical Sash

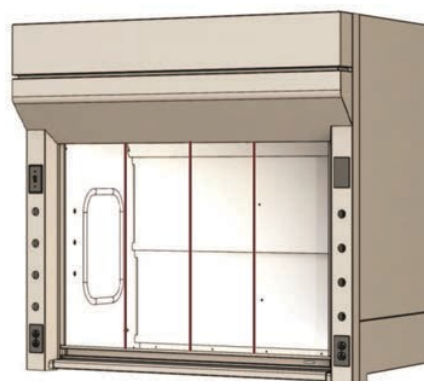

Fume Hood with Combination Sash

Sash System	Vertical Sash		Combination Sash	
	Chain & Sprocket		Chain & Sprocket	
<i>Linear Material</i>	<i>FRP</i>	<i>SS</i>	<i>FRP</i>	<i>SS</i>
1219mm	7271040	7274040	7271050	7274050
1524mm	7371040	7374040	7371050	7374050
1829mm	7471040	7474040	7471050	7474050
2438mm	7571040	7574040	7571050	7574050

*SS liner type 316 with Square corners.

*Contact Laboratory Solutions for exhaust parameters.

Fume Hood with Vertical Sash

Distillation Fume Hoods

This all purpose fume hood is designed to meet most laboratory Constant Air Volume (CAV) designed to mount on a 30" deep counter top.

The Pro bench mounted fume hood is supplied with the following standard features:

- Dual vertical rising sash.
- An automatic compensating upper by-pass.
- Optional restricted by-pass damper.
- Cable or Chain & Sprocket sash system.
- A lower airfoil by-pass with electrical cord notches.
- A UL/CSA approved fluorescent light fixture
- Both corner posts pre-punched to accept a nominal of 5 plumbing fittings per post.
- Removable interior access panel in each side wall, two per side.
- Removable exterior side panels.

Optional Features:

- Stainless, Epoxy, PVC liners
- Automatic Sash Mechanism
- Distillation rack
- Base stand

Base Stand:

- Fully welded tables are 9-3/4" high x 29" deep with
- 2" square tube legs and supplied with leveling glides.
- Tables larger than 48" wide are supplied with six legs
- Tables will support an 1800lb load.
- Comes with PVC boots and levelers.

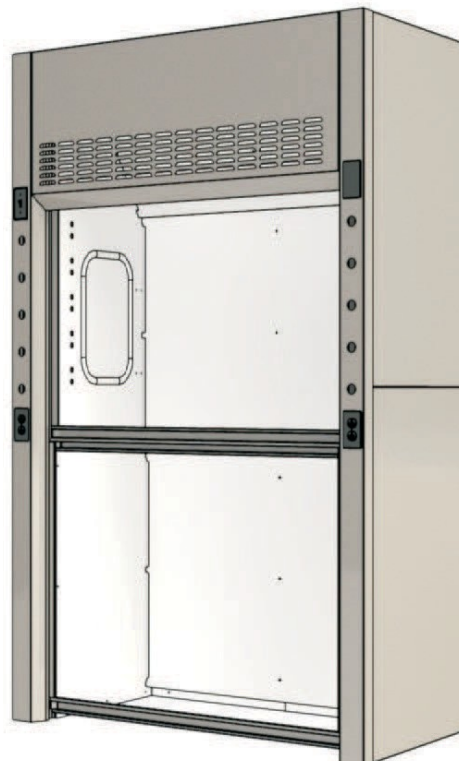

Distillation Fume Hood with Dual vertical sash

Sash System	Vertical Sash				Base Stand
	Cable & Pulley		Chain & Sprocket		
Liner Material	FRP	SS	FRP	SS	
914mm	7121004	7124004	7121044	7124044	DTF1036
1219mm	7221004	7224004	7221044	7224044	DTF1048
1524mm	7321004	7324004	7321044	7324044	DTF1060
1829mm	7421004	7424004	7421044	7424044	DTF1072
2438mm	7521004	7524004	7521044	7524044	DTF1096
1000mm	7B21004	7B24004	7B21044	7B24044	DTF100B
1500mm	7C21004	7C24004	7C21044	7C24044	DTF100C
2000mm	7D21004	7D24004	7D21044	7D24044	DTF100D

*SS liner type 316 with Square corners.

*Contact Laboratory Solutions for exhaust parameters.

Walk-in Fume Hoods

This all purpose fume hood is designed to meet most laboratory Constant Air Volume (CAV) or Variable Air Volume (VAV) requirements. Designed to sit directly on laboratory floor.

The Pro fume hood is supplied with the following standard features:

- Dual vertical rising or optional upper combo sash.
- A UL/CSA approved fluorescent light fixture.
- Both corner posts pre-punched to accept a nominal of 5 plumbing fittings per post.
- Removable interior access panel in each side wall, two per side.
- Electrical Receptacles.
- Removable exterior side panels.
- Floor mounted fume hoods are designed to operate with only one sash open.
- Sash closes within 1” off the floor.

Optional Features:

- Stainless, Epoxy, PVC liners
- Automatic Sash Mechanism
- Distillation Rack

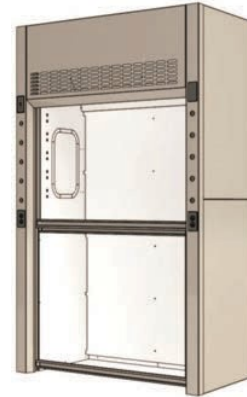

Walk-in Fume Hood with Upper Combination Sash



Walk-in Fume Hood with Dual Vertical Sash

Walk-in Fume Hoods

Sash System	Dual Vertical Sash				Upper Combination	
	Cable & Pulley		Chain & Sprocket		Cable & Pulley	
Liner Material	FRP	SS	FRP	SS	FRP	SS
914mm	7121001	7124001	7121041	7124041	--	--
1219mm	7221001	7224001	7221041	7224041	7221051	7224051
1524mm	7321001	7324001	7321041	7324041	7321051	7324051
1829mm	7421001	7424001	7421041	7424041	7421051	7424051
2438mm	7521001	7524001	7521041	7524041	7521051	7524051
1000mm	7B21001	7B24001	7B21041	7B24041	--	--
1500mm	7C21001	7C24001	7C21041	7C24041	7C21051	7C24051
2000mm	7D21001	7D24001	7D21041	7D24041	7D21051	7D24051

*SS liner type 316 with Square corners.

*Contact Laboratory Solutions for exhaust parameters.

Canopy Hoods

Exhaust canopies are primarily used to exhaust steam, odors and heat. In a work area where the expense and capabilities of a fume hood are not justified.

- Available in either wall or island configurations.
- Standard 18" high.
- Integrally welded construction.
- Integral continuous condensation catch edge.
- Integral duct stub.
- Steel rod suspension.
- Standard fixed baffle (not available with fluorescent light option).
- Optional UL/CSA approved fluorescent light fixture complete with bulbs.
- Powder coated and stainless steel construction available.

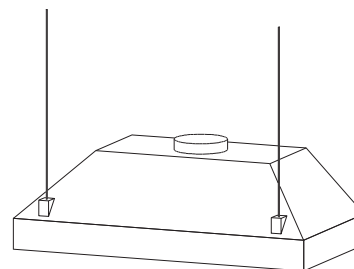

Wall Canopy Hood

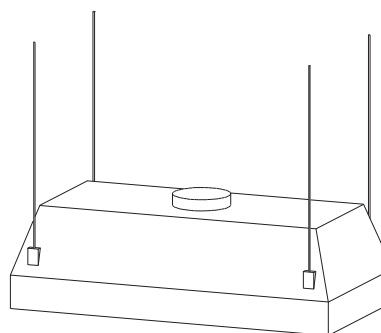

Island Canopy Hood

Optional Light Fixture:

- Complete with a light enclosure.
- Fixed baffle not available when ordering fluorescent light.
- Wire from light to junction box is not concealed.

Wall Canopy Hoods

Width	30" Deep			36" Deep			
	Duct Dia	Painted	304 SS	316 SS	Painted	304 SS	316 SS
914mm	10"	CWP1236	CWR1236	CWS1236	CWP1336	CWR1336	CWS1336
1219mm	10"	CWP1248	CWR1248	CWS1248	CWP1348	CWR1348	CWS1348
1524mm	12"	CWP1260	CWR1260	CWS1260	CWP1360	CWR1360	CWS1360
1829mm	12"	CWP1272	CWR1272	CWS1272	CWP1372	CWR1372	CWS1372
2438mm	2@10"	CWP1296	CWR1296	CWS1296	CWP1396	CWR1396	CWS1396
1000mm	10"	CWP120A	CWR120A	CWS120A	CWP130A	CWR130A	CWS130A
1513mm	12"	CWP120B	CWR120B	CWS120B	CWP130B	CWR130B	CWS130B
2000mm	12"	CWP120C	CWR120C	CWS120C	CWP130C	CWR130C	CWS130C

Island Canopy Hoods

Width	30" Deep			36" Deep			
	Duct Dia	Painted	304 SS	316 SS	Painted	304 SS	316 SS
914mm	10"	CIP1236	CIR1236	CIS1236	CIP1336	CIR1336	CIS1336
1219mm	10"	CIP1248	CIR1248	CIS1248	CIP1348	CIR1348	CIS1348
1524mm	12"	CIP1260	CIR1260	CIS1260	CIP1360	CIR1360	CIS1360
1829mm	12"	CIP1272	CIR1272	CIS1272	CIP1372	CIR1372	CIS1372
2438mm	2@10"	CIP1296	CIR1296	CIS1296	CIP1396	CIR1396	CIS1396
1000mm	10"	CIP120A	CIR120A	CIS120A	CIP130A	CIR130A	CIS130A
1513mm	12"	CIP120B	CIR120B	CIS120B	CIP130B	CIR130B	CIS130B
2000mm	12"	CIP120C	CIR120C	CIS120C	CIP130C	CIR130C	CIS130C

BIOLOGICAL SAFETY

Laboratory Solutions offers Biological Safety Cabinets manufactured by Labconco Corporation, USA. Labconco is a ISO 9001 certified company that manufactures products that adhere to high standards including ETL and NSF standard 49.

Biosafety Cabinets

Purifier Logic®+ Class II, Type A2 and Type B2 Biological Safety Cabinets provide personnel, product and environmental protection from hazardous particulates and agents that require Biosafety Level 1, 2 or 3 containment. Purifier Cell Logic+ Type A2 and B2 Biosafety Cabinets have features specialized for cell research.

The Purifier Axiom® Class II, Type C1 is the first biological safety cabinet that can be used in a recirculating Type A mode for standard microbiological work, or can be connected to an exhaust system to function in Type B mode for handling hazardous chemical vapors or radionuclides. The Axiom is a finalist for the 2016 R&D 100 Awards for Innovation.

Purifier Class I and HEPA Filtered Enclosures provide personnel and environmental protection and are ideal for procedures that generate fine dust, handling suspicious mail, or weighing hazardous powders. They offer an economical alternative to Class II cabinets when applications do not require product protection.

Class II, Type A2

Purifier Cell Logic+ Class II, Type A2 Biosafety Cabinets have unique features that address the unique needs of cell research. Some models have a modified sash that accommodates a microscope. Other models have a temperature-controlled work area on the work surface to keep cells at the proper temperature for viability.

Both Purifier Logic+ and Cell Logic+ Class II, Type A2 Biosafety Cabinets have the same airflow pattern to achieve personnel and product protection. During operation, room air is drawn into the inlet grille at the work access opening and through a supply HEPA filter. Approximately 70% of the HEPA-filtered air is circulated through the cabinet, while 30% passes through an exhaust HEPA filter and is discharged. These biohazard cabinets are designed to discharge HEPA-filtered exhaust air directly into the laboratory, or into an exhaust system through the optional Canopy Connection. When canopy-ducted, these biological safety cabinets may be used for applications involving minute quantities of volatile toxic chemicals and tracer amounts of radionuclides as an adjunct to microbiological research.



Class II, Type A2 BSC with Base Stand

Class II, Type B2

Purifier Cell Logic+ Class II, Type B2 Biosafety Cabinets have unique features that address the unique needs of cell research. Some models have a modified sash that accommodates a microscope. Other models have a temperature-controlled work area on the work surface to keep cells at the proper temperature for viability.

Both Purifier Logic+ and Cell Logic+ Class II, Type B2

Biosafety Cabinets have the same airflow pattern to achieve personnel and product protection.

These biological safety cabinets are designed to be hard ducted to the outside. During operation, room air is drawn into the top of the cabinet and through a supply HEPA filter. This filtered air flows downward through the work area. Room air is also drawn into the inlet grille located at the work access opening. All of the contaminated air passes through the exhaust HEPA filter. A dedicated exhaust system and remote blower discharge 100% of the filtered exhaust air from the laboratory. Since none of the air is recirculated, these biohazard cabinets may be used for work with agents treated with volatile toxic chemicals and radionuclides.



Class II, Type C1 BSC with Base Stand

Class II, Type B2 BSC with Base Stand

Class II, Type C1

The Purifier Axiom Class II, Type C1 is the first biological safety cabinet that can be used in a recirculating Type A mode for standard microbiological work, or can be connected to an exhaust system to function in Type B mode for handling hazardous chemical vapors or radionuclides. Because of the efficient, well-defined airflow pattern over its work surface, the Axiom is safer and easier to operate than traditional biosafety cabinets.

The patent-pending design of the Chem-Zone™ maximizes chemical safety by creating a large, clearly defined area within the enclosure, bringing peace of mind during chemical handling. Other features that make the Axiom safe and easy to operate include its ergonomic Inclination™ Technology, the intuitive MyLogic™ Operating System and Active Protection Protocol.

The Axiom provides protection for personnel, product and the laboratory environment by filtering hazardous particulates and aerosols, such as agents that require Biosafety Level 1, 2 or 3 containment, with the option of venting away hazardous fumes. Type C1 enclosures may also be used for a wide variety of applications that incorporate antineoplastic drugs, genetic material, carcinogens, allergens, or other airborne hazards.

WORKSURFACE

Different laboratories have different worksurface requirements. Criteria for worksurface selection depends on individual laboratory needs. Common features of laboratory worksurfaces are chemical resistance, heat resistance, scratch resistance, load capacity, durability and surface hygiene.

Laboratory Solutions provides a range of worktops suitable for laboratory applications.

Epoxy Resin

- Epoxy Resin worksurfaces are widely used for harsh laboratory environment due to their outstanding qualities of chemical resistance, non-flammability, non-absorbency, vibration damping and cleanability.
- Ideal for education and research laboratories
- 19 and 25mm thickness.
- Available in industry standard black colour.
- Other colours available on special order.



Phenolic Resin

- Phenolic resin countertops are ideal for multi-purpose laboratories.
- Phenolic resin has excellent physical and mechanical properties including chemical and bacterial resistance.
- Ideal for analytical, microbial or chemical labs.
- 6, 13, 20 and 25mm thickness available.
- Range of colours to choose from.



Ceramic

- Ceramic worktops are made of all natural material
- Ceramic has excellent chemical and heat resistance properties.
- These tops highly suitable for laboratories dealing with extremely corrosive chemicals and high temperatures.
- Available in custom sizes, thicknesses and edges.
- Limited colours to choose from.



Stainless Steel

- Made from 16 and 18G, 304 and 316 stainless steel with #4 finish.
- Excellent chemical resistance and physical properties.
- Ideal for food, biological, microbial, nuclear, radiological labs.
- Available in standard 25mm thickness with square or marine edge.
- Integrated sinks available.



Melamine Laminate

- Made from melamine coated particle board.
- Low chemical, physical and mechanical resistance properties.
- Ideal for write-up areas, office desks, receptions.
- Available in range of colours.



Solid Wood

- Welded wood tops are made from heavy duty maple wood.
- These tops are excellent physical and mechanical properties.
- Ideal for arts classrooms, mechanical workshops and industrial labs.
- Available in custom sizes and varying thicknesses from 25mm to 44mm



Polypropylene

- Polypropylene (PP) worktops are thermoplastic polymer with excellent chemical resistance properties.
- PP has low heat resistance, but is a very good option for labs requiring a high level of hygiene and cleanliness.
- Custom sizes and thicknesses.
- Integrated sinks and sink tops available.



Granite

- Natural stone made of igneous rock.
- Low in chemical resistance, but good physical and mechanical properties.
- Can be used in labs that do not use harsh chemicals.
- Black most commonly used in labs.
- Also available in natural colours and textures.



Quartz

- Engineered stone made of 90% quartz and the rest resins, polymers and pigments.
- Good mechanical and physical properties, non porous.
- Good for basic labs, clinics, classrooms.
- Available in range of colours and thicknesses.



Solid Surface

- Commonly referred as Corian.
- Stain resistant, non porous, seamless, repairable transformable and renewable.
- Poor resistance to heat and scratches.
- Suitable for nurse stations, reception desk and office furniture.
- Available in range of colours and 6, 12 & 19mm thicknesses.



Glass

- Made from tempered glass.
- Low chemical, physical and mechanical resistance properties.
- Ideal for write-up areas, office desks, receptions.

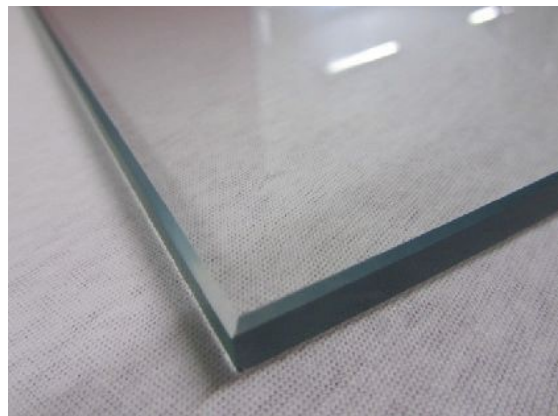

Worktop Edge Profiles

Laboratory Solutions offers different type of edge profiles. Depending on worktop material suitable edge profile can be fabricated. Some commonly used edge profiles are shown below.

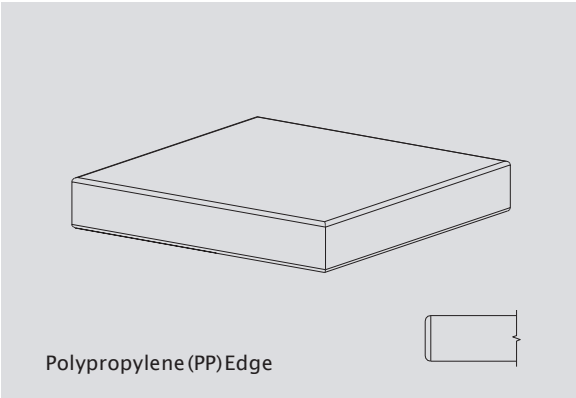
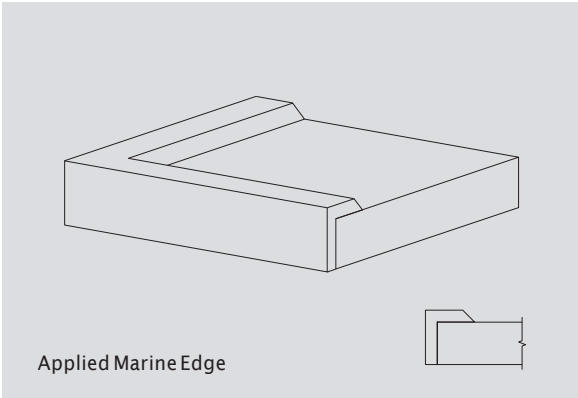
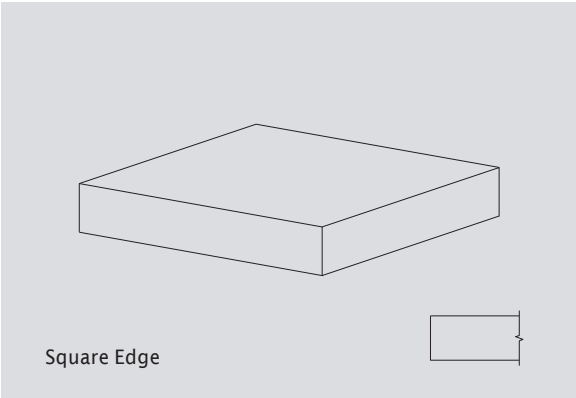
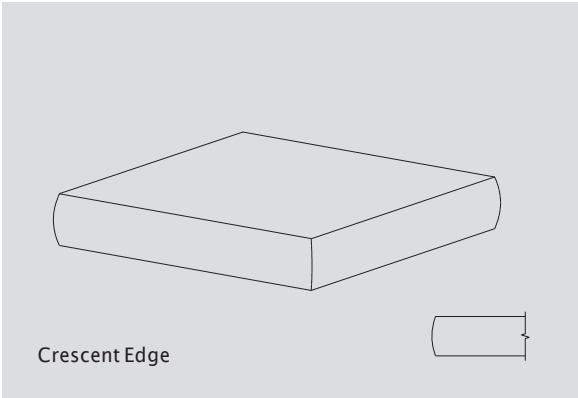
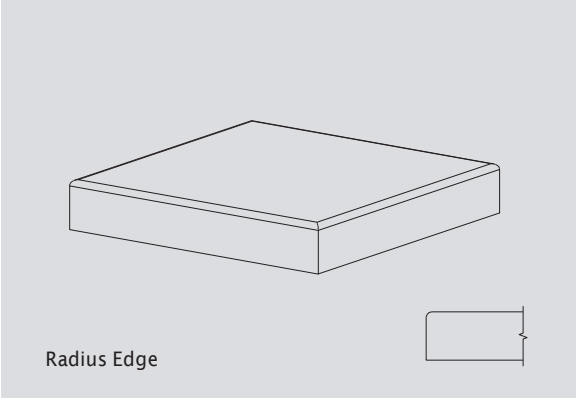
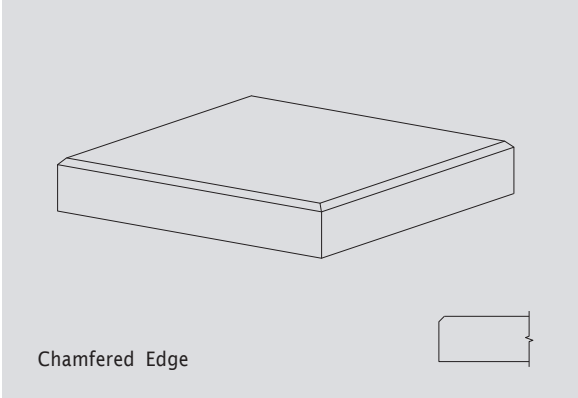

SERVICE FIXTURES

Sinks

Epoxy Sinks - Durcon

Drop-in Sinks			
Part#	Length	Width	Depth
D15	406	305	203
D30	457	381	274
D50	610	406	211
D52	610	457	279
D55	635	381	254



Drop-in sink

Undermount Sinks			
Part#	Length	Width	Depth
U15	406	305	203
U30	457	381	279
U50	610	406	203
U52	599	447	274
U55	635	381	254



Undermount sink

Cupsinks					
Part#	Shape	Length	Width	Depth	Height
TS04	Oval	145	69	94	211
TS12	Oval	224	69	147	254
TS18	Rectangle	345	112	137	251
TS07	Round	152	152	152	290



Oval Cupsink

Epoxy Sinks - Simmons

Drop-in Sinks			
Part#	Length	Width	Depth
SS6-DI	350	300	200
SM8-DI	450	367	195
SEL16-DI	600	450	300
SVL 15-DI	635	450	300



Drop-in sink

Undermount Sinks			
Part#	Length	Width	Depth
SS6	350	300	200
SM8	450	365	200
SEL16	600	450	295
SVL 15	635	381	254



Undermount sink

Polypropylene Sinks

Drop-in/Undermount Sinks				
Part#	Length	Width	Depth	Colour
42-4040PG	400	400	250	Grey
42-4040PB	400	400	250	Black
42-5040PG	500	400	250	Grey
42-5040PB	500	400	250	Black



Drop-in/Undermount sinks

Cupsinks					
Part#	Shape	Length	Width	Depth	Colour
42-497VG	Oval	150	70	135	Grey
42-497	Oval	150	70	135	Black
42-498VG	Oval	230	75	155	Grey
42-498	Oval	230	75	155	Black
42-490*	Rectangle	300	120	111	Light Grey



Oval cupsink



Wall mounted cupsink

* Wall Mounted Cupsink

Stainless Steel Sinks

Stainless steel sinks are available in standard sizes or custom made to specifications including integrated drainboards and worktops. Contact Laboratory Solutions for your specific needs.



Sink with integrated drainboard



Undermount sink



Drop-in sinks

Accessories



Universal P-Trap



Bottle Trap



Waste Fitting



Overflow Pipe

Pegboards

Epoxy

<i>Part#</i>	<i>Height (mm)</i>	<i>Width (mm)</i>	<i>Pegs</i>
PB1824	457	610	21
PB2430	610	762	39
PB3030	762	762	46
PB3036	762	914	56
PB3636	914	914	68

Each pegboard made of 25mm thick black epoxy with stainless steel drip tray and black polypropylene pegs. Custom sizes and configurations available.



Polypropylene

<i>Part#</i>	<i>Height (mm)</i>	<i>Width (mm)</i>	<i>Pegs</i>
51-4350G	600	450	28
51-4351G	900	450	43
51-4352G	1200	450	58

Grey Polypropylene pegboard with drain pan and drain. Suitable for wall hanging.



Stainless Steel

<i>Part#</i>	<i>Height (mm)</i>	<i>Width (mm)</i>	<i>Pegs</i>
V1824	457	610	15
V2430	610	762	32
V3030	762	762	50
V3036	762	914	40
V3636	914	914	66

Pegboard constructed from 20 gauge, type 304 stainless steel, polished to #4 finish. Supplied with integral drip tray, wall brackets, white pegs and clear plastic draining tube. Add-on accessories available.



PVC / Acrylic / Phenolic

Pegboards are also available in PVC, Acrylic and Phenolic material in various sizes and configurations. Contact Laboratory Solutions for more information.

Plumbing Fixtures

Water Faucets

Worktop Mounted
Cold Water Faucet

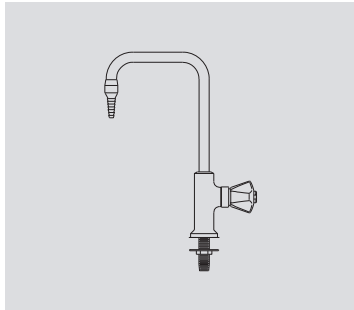

Worktop Mounted
Cold Water Faucet

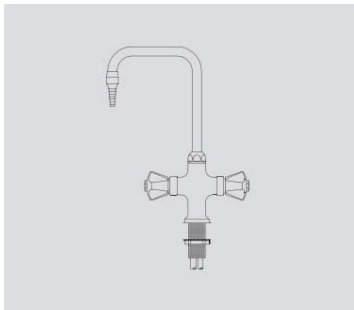

Worktop Mounted
Hot & Cold Water
Faucet with Blade
Handles

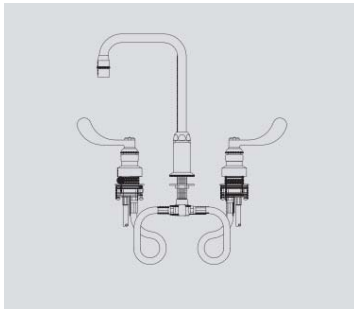

Worktop Mounted
Pure Water Faucet
(with PP lining)

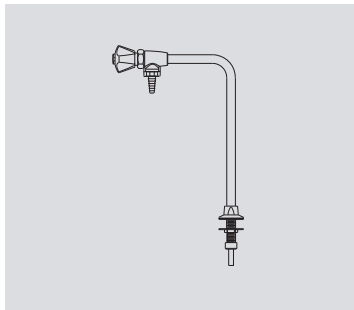

Worktop Mounted
Hot & Cold
Pre-rinse unit



Gas Valves

Worktop Mounted
Single Ball Valve

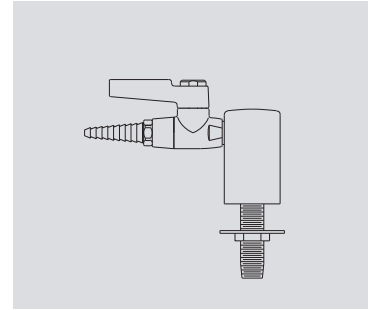

Worktop Mounted
Double Ball Valve

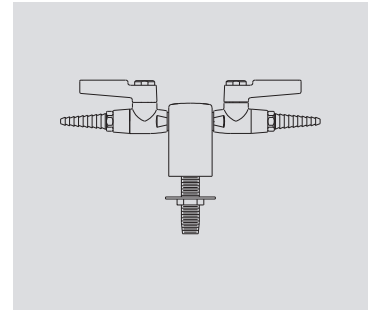

Worktop Mounted
Single Needle
Valve

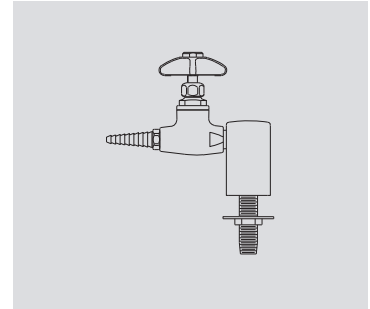

Worktop Mounted
Double Needle
Valve

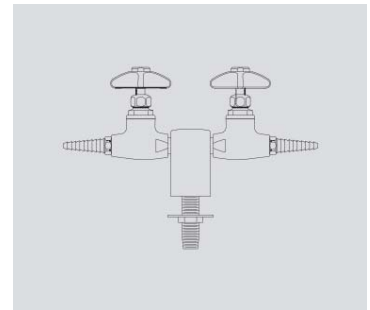

Panel Mounted
Single Needle
Valve

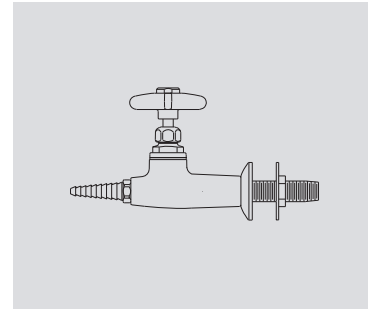

Lab Safety

Eye Wash / Drench Hose

Worktop Mounted
Dual Head Eye Wash
with Drench Hose

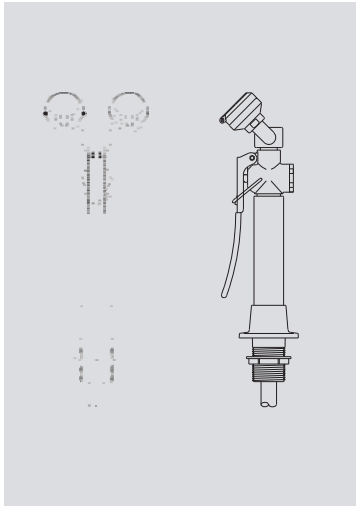

Worktop Mounted
Single Head Eye Wash
with Drench Hose

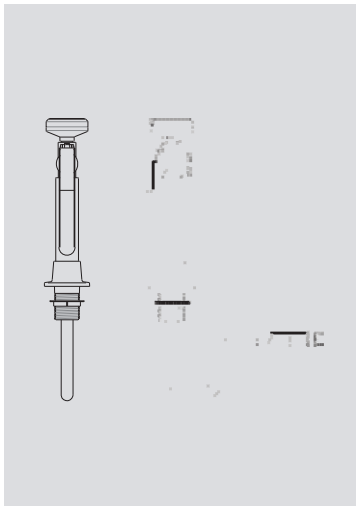

Worktop Mounted
Auto Flow Eye Wash

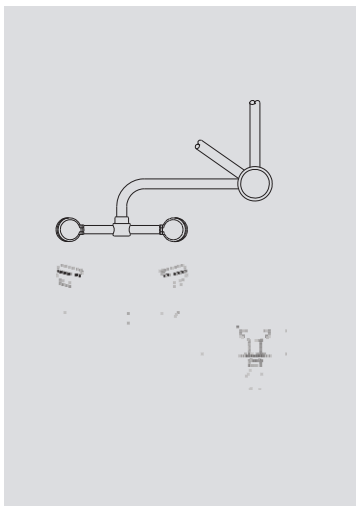

Safety Station / Emergency Shower

Ceiling Mounted
Emergency Shower
with Recessed Stainless
Steel Head

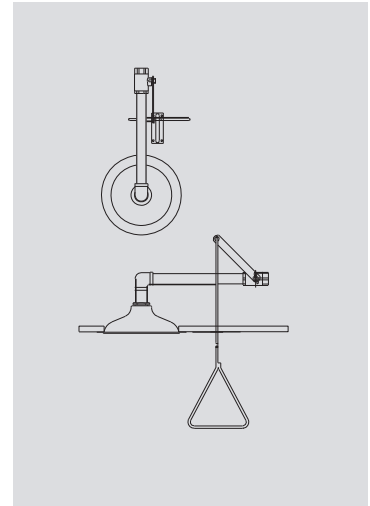

Safety Station with
Eye Wash

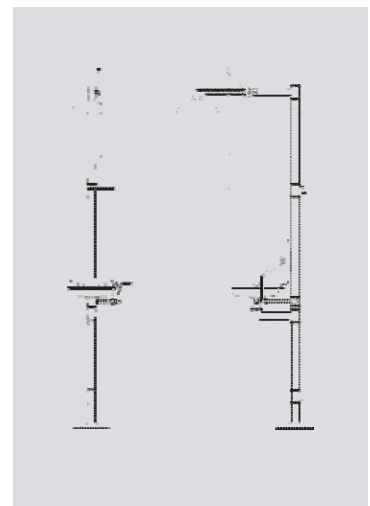

Recessed Safety
Station with Drain Pan
and Exposed Shower
Head

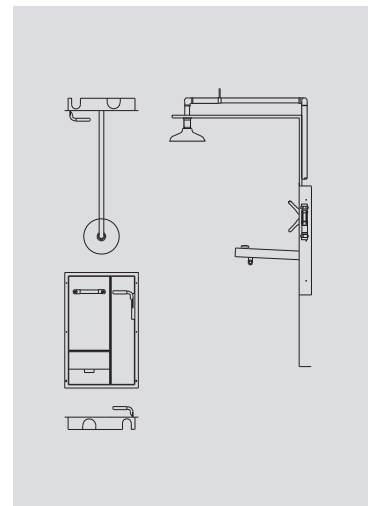

Electrical Trunking

Laboratory Solutions offers a fully customizable electrical trunking made of powder coated extruded aluminium channel with phenolic resin cover and end caps. It is particularly useful for laboratory and workshop environments where safety and extra mechanical strength is necessary.

Aluminium channel is 173mm high x 72mm deep, available in upto 3m lengths. It can be sub-divided into two compartments by a dividing fillet to separate electrical and data cables. Additional components used within the channel are from reputed and certified manufacturers.

Front panel is made of 6mm thick solid phenolic resin. Cutouts are made on CNC machine for fixing different electrical fixtures depending on customer requirement. American, British, European and Indian outlets are available for shipping loose or pre-wired at factory.

Discuss your electrical and data requirements with Laboratory Solutions to provide you with suitable solution.

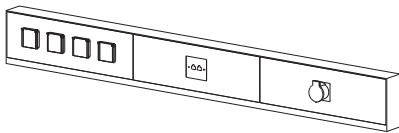

Electrical Trunking shown with IP44 sockets and data ports

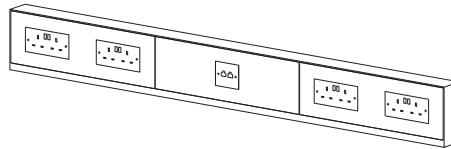

Electrical Trunking shown with standard British sockets and data ports



Extraction Arms

Laboratory Solutions offers a range of Extraction Arms/Spot Extractors used in laboratories. These localized extraction units help extract hazardous fumes and pollutants from close to the source of pollution without hindering the working process.

Each Extraction Arm comprises of a flexible arm, hood and mounting bracket or column. These are available in different materials like polypropylene, aluminum, anti-static and stainless steel. Type of material selected depends on individual laboratory application.

Extraction Arms are connected to remote blower through exhaust duct. Due to their small exhaust volume, they are quieter and more energy efficient.

Stainless steel Extraction Arms are used with Atomic Absorption Spectrometers to extract toxic fumes.

Contact Laboratory Solutions to discuss specific need of extraction arms.



Ceiling Mounted Extraction Arm

Shelving

Wire Shelving

- Unique open wire design minimizes dust accumulation and allow free air circulation and greater visibility.
- Shelves and posts constructed of heavy gauge carbon steel or Type 304 stainless steel.
- Shelves can be adjusted in 1" (25mm) intervals along length of the post.
- Available in Chrome, Metroseal™ and Stainless Steel finishes.
- Available with stationery or Mobile posts.
- Range of shelf accessories.
- Versatile to adapt to changing storage needs.
- Fast, secure and easy assembly.
- Load capacity per shelf 600-800 Lbs.
- Made by InterMetro Corporation, USA.



Solid Shelving

- Solid shelving made of two fold 18 gauge steel with raised edges on all four sides.
- Shelves available in galvanized and stainless steel material.
- Shelves are available in flat or louvered/embossed form.
- Shelves can be adjusted in 1" (25mm) intervals along length of the post.
- Available with stationery or Mobile posts.
- Range of shelf accessories.
- Versatile to adapt to changing storage needs.
- Fast, secure and easy assembly.
- Load capacity per shelf 600-800 Lbs.
- Made by InterMetro Corporation, USA.



Polymer Shelving

- Metromax™ Polymer Shelving is coated with Microban® Antimicrobial coating.
- Excellent protection against rust and corrosion.
- Available in stationery or Mobile posts.
- Easy to clean and maintain with built-in protection against bacteria, mold, mildew and fungus.
- Range of shelf accessories.
- Versatile to adapt to changing storage needs.
- Fast, secure and easy assembly.
- Load capacity per shelf 600-800 Lbs.
- Made by InterMetro Corporation, USA.



SAFETY CABINETS

Justrite Sure-Grip Flammable Safety Cabinet

Part # 894520

Material- 18 Gauge CR Steel

Capacity- 45 gallon, 170 liters

No. of Doors- 2

Door Type- Self Close

Adjustable Shelves- Yes

Dimensions (external)- 43" W x 65"H x 18"D

Approvals- FM

Compliance- NFPA, OSHA, IFC

Colours- Yellow



Justrite Sure-Grip Corrosives/Acid Safety Cabinet

Part # 894522

Material- 18 Gauge CR Steel

Capacity- 45 gallon, 170 liters

No. of Doors- 2

Door Type- Self Close

Adjustable Shelves- Yes

Dimensions (external)- 43" W x 65"H x 18"D

Approvals- FM

Compliance- NFPA, OSHA, IFC

Colours- Blue



Justrite Sure-Grip Undercounter Flammable Safety Cabinet

Part # 892320

Material- 18 Gauge CR Steel

Capacity- 22 gallon, 83 liters

No. of Doors- 2

Door Type- Self Close

Adjustable Shelves- Yes

Dimensions (external)- 35" W x 35"H x 22"D

Approvals- FM

Compliance- NFPA, OSHA, IFC

Colours- Yellow



Justrite Sure-Grip Undercounter Corrosive Cabinet

Part # 892322

Material- 18 Gauge CR Steel

Capacity- 22 gallon, 83 liters

No. of Doors- 2

Door Type- Self Close

Adjustable Shelves- Yes

Dimensions (external)- 35" W x 35"H x 22"D

Approvals- FM

Compliance- NFPA, OSHA, IFC

Colours- Yellow



ASECOS Type 90 Safety Cabinet for Solvent Storage

Part # S90.196.120

Type 90 Safety storage cabinet, tall cabinet with wing door(s), with cylinder locking, integrated adjusting aids to compensate uneven floor, model line S-LINE, model class S-CLASSIC-90, model S90.196.120, type tested in accordance with EN 14470-1, DIN EN 14727, GS certified, CE compliant dimensions
exterior: W x D x H (mm) 1196 x 616 x 1968
interior: W x D x H (mm) 1050 x 524 x 1742

Colour:

corpus: RAL 7035 Light grey, plain door(s):
RAL 7035 Light grey, plain

Interior equipment:

3x HF.M.27065 tray shelf (standard),
L= 150 kg, V= 33 Litre, stainless steel 1.4016,
raw 1x HF.M.16167 bottom collecting sump standard,
V= 56 Litre, stainless steel 1.4301, raw



ASECOS Type 90 Safety Cabinet

Part # SL.196.060.MH

Cabinet for acids and alkalis, tall cabinet with wing door(s) left hinged, with cylinder locking, version horizontal dividing wall, integrated adjusting aids to compensate uneven floor, model line SL-LINE, model class SL-CLASSIC, model SL.196.060.MH type tested in accordance with EN 14727, DIN EN 14727, GS certified dimensions exterior: W x D x H (mm) 597 x 603 x 1965
interior: W x D x H (mm) 485 x 570 x 914

Colour:

RAL 7035 Light grey, plain door(s): RAL 7035 Light grey, plain

Interior equipment:

4x HF.I.14537_N pull-out shelf AbZ, L= 25 kg, V= 11 Litre,
chip-board/polypropylene, raw



ASECOS Type 90 Safety Cabinet for Solvent Storage

Part # UB90.060.059.S

Type 90 Safety storage underbench cabinet,
underbench cabinet with drawer, with cylinder locking and
locking state indicator, model line UB-LINE, model class UB-S-90,
model UB90.060.059.S, type tested in accordance with EN 14470-1,
DIN EN 14727, GS certified, CE compliant dimensions
exterior: W x D x H (mm) 593 x 574 x 600
interior: W x D x H (mm) 470 x 452 x 502



Part # UB90.060.110.2S

Type 90 Safety storage underbench cabinet,
underbench cabinet with 2 drawers, with cylinder locking and
locking state indicator, model line UB-LINE, model class UB-S-90,
model UB90.060.110.2S, type tested in accordance with
EN 14470-1, DIN EN 14727, GS certified, CE compliant dimensions
exterior: W x D x H (mm) 1102 x 574 x 600
interior: W x D x H (mm) 979 x 452 x 502



ASECOS Type 90 Gas Cylinder Cabinet

Part # G90.205.090

Type G90 Gas cylinder cabinet, tall cabinet with wing door(s),
integrated adjusting aids to compensate uneven floor, model line G-LINE,
model class G-ULTIMATE-90, model G90.205.090,
type tested in accordance with EN 14470-2, DIN EN 14727,
GS certified, CE compliant dimensions
exterior: W x D x H (mm) 898 x 615 x 2050
interior: W x D x H (mm) 745 x 425 x 1858

Interior equipment:

1x HF.I.15616_N standard interior equipment gas cylinders,
sheet steel, galvanized and powder-coated



SPECS & OPTIONS

Core

Cabinet carcass is made of High Pressure Laminate (HPL), MDF, Plywood or Phenolic Resin.

Edging

All exposed ends of cabinet and individual parts are edged with PVC using automatic edge banding machine with hot melted glue under high pressure and temperature.

Back and Top

Back and Top of cabinet is made of High Pressure Laminate (HPL), MDF, Plywood or Phenolic Resin.

Drawer Bottom

Drawer Bottom is made of High Pressure Laminate (HPL), MDF, Plywood or Phenolic Resin

Doors/Drawers

Doors and Drawers are made of High Pressure Laminate (HPL), MDF, Plywood or Phenolic Resin

Shelves

Shelves are made of High Pressure Laminate (HPL), MDF, Plywood or Phenolic Resin with PVC edging or finished edges on all sides. Shelves are supported by four shelf pins, adjustable in 25mm increments. Each shelf has load bearing capacity of 60Kgs.

Handles

Various options are available for door/drawer handles that includes full length anodized aluminium grab rail, standard D handles, recessed or custom handle with label holder. Handles are also available in powder coated options.

Hinges

Institutional Single Joint hinge is blended with high quality material, excellent workmanship together with aesthetic design and reliable operation. Various options are available that includes 1100, 1600, 2700 self-closing or standard institutional hinges.

Drawer Slides

Standard, double wall and full extension soft closing drawer slides made by Grass. These slides guarantee optimum lateral stability, synchronized movement and silent running. Loading capacity ranging between 30-70Kg.2

Locks

Doors can be fitted with cylinder locks.

Laboratory Solutions

Laboratory Solutions FZC

P O Box 122461

T5-016, SAIF Zone

Sharjah, UAE

Tel: +971 6 5564121 | Fax: +971 6 5564142 | www.labsol-hnh.com